

Bowdoin

Map Lot 11-10-0

Account 1173

Location LEWIS HILL RD

Card 1 Of 1 7/22/2022

Building Style 0 Not Coded	SF Bsmt Living 0	Layout 0
0.Not Code 4.Cape 8.Log	Fin Bsmt Grade 0 0	1.Typical 4. 7.
1.Conv. 5.Garrison 9.Other	OCCUPANCY 0	2.Inadeq 5. 8.
2.Ranch 6.Split 10.DW	Heat Type 100% 0 Not Coded	3.Poor 6. 9.
3.R Ranch 7.Contemp 11.Church	0.Not Code 4.Steam 8.FI/Wall	Attic 0
Dwelling Units 0	1.HWBB 5.FWA 9.No Heat	1.1/4 Fin 4.Full Fin 7.
Other Units 0	2.HWCI 6.GravWA 11.	2.1/2 Fin 5.FI/Stair 8.
Stories 0	3.H Pump 7.Electric 12.	3.3/4 Fin 6. 9.None
1.1 4.1.5 7.4	Cool Type 0% 9 None	Insulation 0
2.2 5.1.75 8.20	1.Refrig 4.W&C Air 7.	1.Full 4.Minimal 7.
3.3 6.2.5 9.Yurt	2.Evapor 5. 8.	2.Heavy 5. 8.
Exterior Walls 0 Not Coded	3.H Pump 6. 9.None	3.Capped 6. 9.None
0.Not Code 4.Asbestos 8.Concrete	Kitchen Style 0	Unfinished % 0%
1.Wood 5.Stucco 9.Other	1.Modern 4.Obsolete 7.	Grade & Factor 0 0%
2.Vin/Al 6.Brick 10.Board B	2.Typical 5. 8.	1.E Grade 4.B Grade 7.
3.Compos. 7.Stone 12.	3.Old Type 6. 9.None	2.D Grade 5.A Grade 8.
Roof Surface 0	Bath(s) Style 0	3.C Grade 6.AA Grade 9.Same
1.Asphalt 4.Composit 7.	1.Modern 4.Obsolete 7.	SQFT (Footprint) 0
2.Slate 5.Wood 8.	2.Typical 5. 8.	Condition 0
3.Metal 6.Other 9.	3.Old Type 6. 9.None	1.Poor 4.Avg 7.V G
SF Masonry Trim 0	# Rooms 0	2.Fair 5.Avg+ 8.Exc
SEPTIC DESIGN 0	# Bedrooms 0	3.Avg- 6.Good 9.Same
BLDG PERMIT 0	# Full Baths 0	Phys. % Good 0%
Year Built 0	# Half Baths 0	Funct. % Good 100%
Year Remodeled 0	# Addn Fixtures 0	Functional Code 9 None
Foundation 0	# Fireplaces 0	1.Incomp 4.Delap 7.No Power
1.Concrete 4.Wood 7.		2.O-Built 5.Bsmt 8.LongTerm
2.C Block 5.Slab 8.		3.Damage 6.Dbwd 9.None
3.Br/Stone 6.Piers 9.		Econ. % Good 100%
Basement 0		Economic Code None
1.1/4 Bmt 4.Full Bmt 7.		0.None 3.No Power 7.
2.1/2 Bmt 5.None 8.		1.Location 4.Generate 8.
3.3/4 Bmt 6. 9.None		2.Encroach 9.None 9.
Bsmt Gar # Cars 0		Entrance Code 0
Wet Basement 0		1.Interior 4.Vacant 7.Entered
1.Dry 4. 7.		2.Refusal 5.Estimate 8.No
2.Damp 5. 8.		3.Informed 6.Reviewed 9.Land
3.Wet 6. 9.		Information Code 0
		1.Owner 4.Agent 7.
		2.Relative 5.Estimate 8.
		3.Tenant 6.Other 9.



Date Inspected

Additions, Outbuildings & Improvements							
Type	Year	Units	Grade	Cond	Phys.	Funct.	Sound Value
					%	%	1.One Story Fram
					%	%	2.Two Story Fram
					%	%	3.Three Story Fr
					%	%	4.1 & 1/2 Story
					%	%	5.1 & 3/4 Story
					%	%	6.2 & 1/2 Story
					%	%	21.Open Frame Por
					%	%	22.Encl Frame Por
					%	%	23.Attached Garag
					%	%	24.Frame Shed
					%	%	25.Frame Bay Wind
					%	%	26.1SFr Overhang
					%	%	27.Unfin Basement
					%	%	28.Unfinished Att
					%	%	29.Finished Attic

CARD, ROBERT R
941 MEADOW RD
BOWDOIN ME 04287

B2433P68

Previous Owner
CARD, ESTATE OF CLIFFORD R
C/O ROBERT R. CARD, P.R.
941 MEADOW RD
BOWDOIN ME 04287
Sale Date: 2/09/2005

Inspection Witnessed By:

X	Date	Description	Date Insp.

Notes:

Bowdoin

Property Data			Assessment Record																																																																																																																																																																																																																	
Neighborhood 11 Map 11			Year	Land	Buildings	Exempt	Total																																																																																																																																																																																																													
Tree Growth Year 1973			2009	31,190	0	0	31,190																																																																																																																																																																																																													
Farmland Yr 0			2010	32,580	0	0	32,580																																																																																																																																																																																																													
Open Space Yr 0			2011	32,580	0	0	32,580																																																																																																																																																																																																													
Zone/Land Use 11 Residential 1			2012	32,670	0	0	32,670																																																																																																																																																																																																													
Secondary Zone			2013	31,760	0	0	31,760																																																																																																																																																																																																													
Topography			2014	31,510	0	0	31,510																																																																																																																																																																																																													
1.Level 4.Below St 7.LevelBog			2015	30,720	0	0	30,720																																																																																																																																																																																																													
2.Rolling 5.Low 8.Conform			2016	40,660	0	0	40,660																																																																																																																																																																																																													
3.Above St 6.FZone 9.Non-Confor			2017	42,050	0	0	42,050																																																																																																																																																																																																													
Utilities			2018	43,370	0	0	43,370																																																																																																																																																																																																													
1.Public 4.Dr Well 7.Cesspool			2019	42,990	0	0	42,990																																																																																																																																																																																																													
2.Water 5.Dug Well 8.			2020	43,620	0	0	43,620																																																																																																																																																																																																													
3.Sewer 6.Septic 9.None			2021	43,590	0	0	43,590																																																																																																																																																																																																													
Street			2022	37,110	0	0	37,110																																																																																																																																																																																																													
1.Paved 4.Proposed 7.MHG			<table border="1"> <thead> <tr> <th colspan="5">Land Data</th> </tr> <tr> <th rowspan="2">Front Foot</th> <th rowspan="2">Type</th> <th colspan="2">Effective</th> <th colspan="2">Influence</th> <th rowspan="2">Influence Codes</th> </tr> <tr> <th>Frontage</th> <th>Depth</th> <th>Factor</th> <th>Code</th> </tr> </thead> <tbody> <tr> <td>11.Road Frontage</td> <td></td> <td></td> <td></td> <td>%</td> <td></td> <td>1.Unimproved</td> </tr> <tr> <td>12.Delta Triangle</td> <td></td> <td></td> <td></td> <td>%</td> <td></td> <td>2.Excess Frtg</td> </tr> <tr> <td>13.Nabla Triangle</td> <td></td> <td></td> <td></td> <td>%</td> <td></td> <td>3.Topography</td> </tr> <tr> <td>14.Rear Land</td> <td></td> <td></td> <td></td> <td>%</td> <td></td> <td>4.Size/Shape</td> </tr> <tr> <td>15.Miscellaneous</td> <td></td> <td></td> <td></td> <td>%</td> <td></td> <td>5.Access</td> </tr> <tr> <td></td> <td></td> <td></td> <td></td> <td>%</td> <td></td> <td>6.Restriction</td> </tr> <tr> <td></td> <td></td> <td></td> <td></td> <td>%</td> <td></td> <td>7.Open Space</td> </tr> <tr> <td></td> <td></td> <td></td> <td></td> <td>%</td> <td></td> <td>8.View/Environ</td> </tr> <tr> <td></td> <td></td> <td></td> <td></td> <td>%</td> <td></td> <td>9.Fract Share</td> </tr> <tr> <td></td> <td></td> <td></td> <td></td> <td>%</td> <td></td> <td>Acres</td> </tr> <tr> <td></td> <td></td> <td></td> <td></td> <td>%</td> <td></td> <td>30.Rear Land 3</td> </tr> <tr> <td></td> <td></td> <td></td> <td></td> <td>%</td> <td></td> <td>31.Tillable</td> </tr> <tr> <td></td> <td></td> <td></td> <td></td> <td>%</td> <td></td> <td>32.Pasture</td> </tr> <tr> <td></td> <td></td> <td></td> <td></td> <td>%</td> <td></td> <td>33.Orchard</td> </tr> <tr> <td></td> <td></td> <td></td> <td></td> <td>%</td> <td></td> <td>34.Softwood F&O</td> </tr> <tr> <td></td> <td></td> <td></td> <td></td> <td>%</td> <td></td> <td>35.Mixed Wood F&O</td> </tr> <tr> <td></td> <td></td> <td></td> <td></td> <td>%</td> <td></td> <td>36.Hardwood F&O</td> </tr> <tr> <td></td> <td></td> <td></td> <td></td> <td>%</td> <td></td> <td>37.Softwood TG</td> </tr> <tr> <td></td> <td></td> <td></td> <td></td> <td>%</td> <td></td> <td>38.Mixed Wood TG</td> </tr> <tr> <td></td> <td></td> <td></td> <td></td> <td>%</td> <td></td> <td>39.Hardwood TG</td> </tr> <tr> <td></td> <td></td> <td></td> <td></td> <td>%</td> <td></td> <td>40.Wasteland</td> </tr> <tr> <td></td> <td></td> <td></td> <td></td> <td>%</td> <td></td> <td>41.Commercial</td> </tr> <tr> <td></td> <td></td> <td></td> <td></td> <td>%</td> <td></td> <td>42.2nd Site</td> </tr> <tr> <td></td> <td></td> <td></td> <td></td> <td>%</td> <td></td> <td>43.Post Rd</td> </tr> <tr> <td></td> <td></td> <td></td> <td></td> <td>%</td> <td></td> <td>44.Lot Improvemen</td> </tr> <tr> <td></td> <td></td> <td></td> <td></td> <td>%</td> <td></td> <td>45.Subdivision Lo</td> </tr> <tr> <td></td> <td></td> <td></td> <td></td> <td>%</td> <td></td> <td>46.Golf Course</td> </tr> </tbody> </table>					Land Data					Front Foot	Type	Effective		Influence		Influence Codes	Frontage	Depth	Factor	Code	11.Road Frontage				%		1.Unimproved	12.Delta Triangle				%		2.Excess Frtg	13.Nabla Triangle				%		3.Topography	14.Rear Land				%		4.Size/Shape	15.Miscellaneous				%		5.Access					%		6.Restriction					%		7.Open Space					%		8.View/Environ					%		9.Fract Share					%		Acres					%		30.Rear Land 3					%		31.Tillable					%		32.Pasture					%		33.Orchard					%		34.Softwood F&O					%		35.Mixed Wood F&O					%		36.Hardwood F&O					%		37.Softwood TG					%		38.Mixed Wood TG					%		39.Hardwood TG					%		40.Wasteland					%		41.Commercial					%		42.2nd Site					%		43.Post Rd					%		44.Lot Improvemen					%		45.Subdivision Lo					%		46.Golf Course
Land Data																																																																																																																																																																																																																				
Front Foot	Type	Effective						Influence		Influence Codes																																																																																																																																																																																																										
		Frontage	Depth	Factor	Code																																																																																																																																																																																																															
11.Road Frontage				%		1.Unimproved																																																																																																																																																																																																														
12.Delta Triangle				%		2.Excess Frtg																																																																																																																																																																																																														
13.Nabla Triangle				%		3.Topography																																																																																																																																																																																																														
14.Rear Land				%		4.Size/Shape																																																																																																																																																																																																														
15.Miscellaneous				%		5.Access																																																																																																																																																																																																														
				%		6.Restriction																																																																																																																																																																																																														
				%		7.Open Space																																																																																																																																																																																																														
				%		8.View/Environ																																																																																																																																																																																																														
				%		9.Fract Share																																																																																																																																																																																																														
				%		Acres																																																																																																																																																																																																														
				%		30.Rear Land 3																																																																																																																																																																																																														
				%		31.Tillable																																																																																																																																																																																																														
				%		32.Pasture																																																																																																																																																																																																														
				%		33.Orchard																																																																																																																																																																																																														
				%		34.Softwood F&O																																																																																																																																																																																																														
				%		35.Mixed Wood F&O																																																																																																																																																																																																														
				%		36.Hardwood F&O																																																																																																																																																																																																														
				%		37.Softwood TG																																																																																																																																																																																																														
				%		38.Mixed Wood TG																																																																																																																																																																																																														
				%		39.Hardwood TG																																																																																																																																																																																																														
				%		40.Wasteland																																																																																																																																																																																																														
				%		41.Commercial																																																																																																																																																																																																														
				%		42.2nd Site																																																																																																																																																																																																														
				%		43.Post Rd																																																																																																																																																																																																														
				%		44.Lot Improvemen																																																																																																																																																																																																														
				%		45.Subdivision Lo																																																																																																																																																																																																														
				%		46.Golf Course																																																																																																																																																																																																														
TG PLAN YEAR 2014			Square Foot																																																																																																																																																																																																																	
Tif District # 0			16.Regular Lot																																																																																																																																																																																																																	
Sale Data			17.Secondary Lot																																																																																																																																																																																																																	
			18.Hydro Facility																																																																																																																																																																																																																	
Sale Date			19.Improvements																																																																																																																																																																																																																	
Price			20.Base 3 (Fract)																																																																																																																																																																																																																	
Sale Type			21.Base 1 (Fract)																																																																																																																																																																																																																	
1.Land 4.Mobile 7.C/I L&B			22.Base 2 (Fract)																																																																																																																																																																																																																	
2.L & B 5.Other 8.			23.Base 3																																																																																																																																																																																																																	
3.Building 6.C/I Land 9.			Acres																																																																																																																																																																																																																	
Financing			24.Base 1																																																																																																																																																																																																																	
1.Convent 4.Seller 7.			25.Base 2																																																																																																																																																																																																																	
2.FHA/VA 5.Private 8.			26.Frontage 1																																																																																																																																																																																																																	
3.Assumed 6.Cash 9.Unknown			27.Rear Land 4																																																																																																																																																																																																																	
Validity 2 Related Parties			28.Rear Land 1																																																																																																																																																																																																																	
1.Valid 4.Split 7.Renovate			29.Rear Land 2																																																																																																																																																																																																																	
2.Related 5.Partial 8.Other																																																																																																																																																																																																																				
3.Distress 6.Exempt 9.Short																																																																																																																																																																																																																				
Verified																																																																																																																																																																																																																				
1.Buyer 4.Agent 7.Family																																																																																																																																																																																																																				
2.Seller 5.Pub Rec 8.Other																																																																																																																																																																																																																				
3.Lender 6.MLS 9.																																																																																																																																																																																																																				
			Total Acreage 97.00																																																																																																																																																																																																																	

Bowdoin

Map Lot 11-11-0

Account 1174

Location LEWIS HILL RD

Card 1 Of 1 7/22/2022

Building Style 0 Not Coded	SF Bsmt Living 0	Layout 0
0.Not Code 4.Cape 8.Log	Fin Bsmt Grade 0 0	1.Typical 4. 7.
1.Conv. 5.Garrison 9.Other	OCCUPANCY 0	2.Inadeq 5. 8.
2.Ranch 6.Split 10.DW	Heat Type 100% 0 Not Coded	3.Poor 6. 9.
3.R Ranch 7.Contemp 11.Church	0.Not Code 4.Steam 8.FI/Wall	Attic 0
Dwelling Units 0	1.HWBB 5.FWA 9.No Heat	1.1/4 Fin 4.Full Fin 7.
Other Units 0	2.HWCI 6.GravWA 11.	2.1/2 Fin 5.FI/Stair 8.
Stories 0	3.H Pump 7.Electric 12.	3.3/4 Fin 6. 9.None
1.1 4.1.5 7.4	Cool Type 0% 9 None	Insulation 0
2.2 5.1.75 8.20	1.Refrig 4.W&C Air 7.	1.Full 4.Minimal 7.
3.3 6.2.5 9.Yurt	2.Evapor 5. 8.	2.Heavy 5. 8.
Exterior Walls 0 Not Coded	3.H Pump 6. 9.None	3.Capped 6. 9.None
0.Not Code 4.Asbestos 8.Concrete	Kitchen Style 0	Unfinished % 0%
1.Wood 5.Stucco 9.Other	1.Modern 4.Obsolete 7.	Grade & Factor 0 0%
2.Vin/Al 6.Brick 10.Board B	2.Typical 5. 8.	1.E Grade 4.B Grade 7.
3.Compos. 7.Stone 12.	3.Old Type 6. 9.None	2.D Grade 5.A Grade 8.
Roof Surface 0	Bath(s) Style 0	3.C Grade 6.AA Grade 9.Same
1.Asphalt 4.Composit 7.	1.Modern 4.Obsolete 7.	SQFT (Footprint) 0
2.Slate 5.Wood 8.	2.Typical 5. 8.	Condition 0
3.Metal 6.Other 9.	3.Old Type 6. 9.None	1.Poor 4.Avg 7.V G
SF Masonry Trim 0	# Rooms 0	2.Fair 5.Avg+ 8.Exc
SEPTIC DESIGN 0	# Bedrooms 0	3.Avg- 6.Good 9.Same
BLDG PERMIT 0	# Full Baths 0	Phys. % Good 0%
Year Built 0	# Half Baths 0	Funct. % Good 100%
Year Remodeled 0	# Addn Fixtures 0	Functional Code 9 None
Foundation 0	# Fireplaces 0	1.Incomp 4.Delap 7.No Power
1.Concrete 4.Wood 7.		2.O-Built 5.Bsmt 8.LongTerm
2.C Block 5.Slab 8.		3.Damage 6.Dbwd 9.None
3.Br/Stone 6.Piers 9.		Econ. % Good 100%
Basement 0		Economic Code None
1.1/4 Bmt 4.Full Bmt 7.		0.None 3.No Power 7.
2.1/2 Bmt 5.None 8.		1.Location 4.Generate 8.
3.3/4 Bmt 6. 9.None		2.Encroach 9.None 9.
Bsmt Gar # Cars 0		Entrance Code 0
Wet Basement 0		1.Interior 4.Vacant 7.Entered
1.Dry 4. 7.		2.Refusal 5.Estimate 8.No
2.Damp 5. 8.	3.Informed 6.Reviewed 9.Land	
3.Wet 6. 9.	Information Code 0	
		1.Owner 4.Agent 7.
		2.Relative 5.Estimate 8.
		3.Tenant 6.Other 9.

Date Inspected

Additions, Outbuildings & Improvements							
Type	Year	Units	Grade	Cond	Phys.	Funct.	Sound Value
					%	%	1.One Story Fram
					%	%	2.Two Story Fram
					%	%	3.Three Story Fr
					%	%	4.1 & 1/2 Story
					%	%	5.1 & 3/4 Story
					%	%	6.2 & 1/2 Story
					%	%	21.Open Frame Por
					%	%	22.Encl Frame Por
					%	%	23.Attached Garag
					%	%	24.Frame Shed
					%	%	25.Frame Bay Wind
					%	%	26.1SFr Overhang
					%	%	27.Unfin Basement
					%	%	28.Unfinished Att
					%	%	29.Finished Attic

COOLIDGE, THOMAS C
GREENBAUM, WENDY R
P. O. BOX 88
BOWDOINHAM ME 04008

B1387P347

Inspection Witnessed By:

No./Date	Description	Date Insp.
X		

Notes:

Bowdoin

Property Data			Assessment Record						
Neighborhood 11 Map 11			Year	Land	Buildings	Exempt	Total		
Tree Growth Year 0			2009	36,900	0	0	36,900		
Farmland Yr 0			2010	36,900	0	0	36,900		
Open Space Yr 0			2011	36,900	0	0	36,900		
Zone/Land Use 11 Residential 1			2012	39,400	0	0	39,400		
Secondary Zone			2013	39,400	0	0	39,400		
Topography			2014	39,400	0	0	39,400		
1.Level 4.Below St 7.LevelBog			2015	39,400	0	0	39,400		
2.Rolling 5.Low 8.Conform			2016	39,400	0	0	39,400		
3.Above St 6.FZone 9.Non-Confor			2017	39,400	0	0	39,400		
Utilities			2018	39,400	0	0	39,400		
1.Public 4.Dr Well 7.Cesspool			2019	39,400	0	0	39,400		
2.Water 5.Dug Well 8.			2020	39,400	0	0	39,400		
3.Sewer 6.Septic 9.None			2021	39,400	0	0	39,400		
Street			2022	39,400	0	0	39,400		
1.Paved 4.Proposed 7.MHG			Land Data						
2.Semi Imp 5.R/O/W 8.DIS									
3.Gravel 6.MHP 9.None			Front Foot	Type	Effective		Influence		Influence Codes
TG PLAN YEAR 0			11.Road Frontage		Frontage	Depth	Factor	Code	
Tif District # 0			12.Delta Triangle				%		1.Unimproved
Sale Data			13.Nabla Triangle				%		2.Excess Frtg
Sale Date			14.Rear Land				%		3.Topography
Price			15.Miscellaneous				%		4.Size/Shape
Sale Type							%		5.Access
1.Land 4.Mobile 7.C/I L&B			Square Foot	Square Feet					6.Restriction
2.L & B 5.Other 8.			16.Regular Lot				%		7.Open Space
3.Building 6.C/I Land 9.			17.Secondary Lot				%		8.View/Environ
Financing			18.Hydro Facility				%		9.Fract Share
1.Convent 4.Seller 7.			19.Improvements				%		Acres
2.FHA/VA 5.Private 8.			20.Base 3 (Fract)				%		30.Rear Land 3
3.Assumed 6.Cash 9.Unknown							%		31.Tillable
Validity			Fract. Acre	Acres/Sites					32.Pasture
1.Valid 4.Split 7.Renovate			21.Base 1 (Fract)	23	1.00	100	%	0	33.Orchard
2.Related 5.Partial 8.Other			22.Base 2 (Fract)	28	21.00	100	%	0	34.Softwood F&O
3.Distress 6.Exempt 9.Short			23.Base 3				%		35.Mixed Wood F&O
Verified			Acres				%		36.Hardwood F&O
1.Buyer 4.Agent 7.Family			24.Base 1				%		37.Softwood TG
2.Seller 5.Pub Rec 8.Other			25.Base 2				%		38.Mixed Wood TG
3.Lender 6.MLS 9.			26.Frontage 1				%		39.Hardwood TG
			27.Rear Land 4				%		40.Wasteland
			28.Rear Land 1				%		41.Commercial
			29.Rear Land 2				%		42.2nd Site
			Total Acreage		22.00				43.Post Rd
									44.Lot Improvemen
									45.Subdivision Lo
									46.Golf Course

Bowdoin

Map Lot 11-12-0

Account 1175

Location LEWIS HILL RD

Card 1 Of 1 7/22/2022

Building Style 0 Not Coded	SF Bsmt Living 0	Layout 0
0.Not Code 4.Cape 8.Log	Fin Bsmt Grade 0 0	1.Typical 4. 7.
1.Conv. 5.Garrison 9.Other	OCCUPANCY 0	2.Inadeq 5. 8.
2.Ranch 6.Split 10.DW	Heat Type 100% 0 Not Coded	3.Poor 6. 9.
3.R Ranch 7.Contemp 11.Church	0.Not Code 4.Steam 8.FI/Wall	Attic 0
Dwelling Units 0	1.HWBB 5.FWA 9.No Heat	1.1/4 Fin 4.Full Fin 7.
Other Units 0	2.HWCI 6.GravWA 11.	2.1/2 Fin 5.FI/Stair 8.
Stories 0	3.H Pump 7.Electric 12.	3.3/4 Fin 6. 9.None
1.1 4.1.5 7.4	Cool Type 0% 9 None	Insulation 0
2.2 5.1.75 8.20	1.Refrig 4.W&C Air 7.	1.Full 4.Minimal 7.
3.3 6.2.5 9.Yurt	2.Evapor 5. 8.	2.Heavy 5. 8.
Exterior Walls 0 Not Coded	3.H Pump 6. 9.None	3.Capped 6. 9.None
0.Not Code 4.Asbestos 8.Concrete	Kitchen Style 0	Unfinished % 0%
1.Wood 5.Stucco 9.Other	1.Modern 4.Obsolete 7.	Grade & Factor 0 0%
2.Vin/Al 6.Brick 10.Board B	2.Typical 5. 8.	1.E Grade 4.B Grade 7.
3.Compos. 7.Stone 12.	3.Old Type 6. 9.None	2.D Grade 5.A Grade 8.
Roof Surface 0	Bath(s) Style 0	3.C Grade 6.AA Grade 9.Same
1.Asphalt 4.Composit 7.	1.Modern 4.Obsolete 7.	SQFT (Footprint) 0
2.Slate 5.Wood 8.	2.Typical 5. 8.	Condition 0
3.Metal 6.Other 9.	3.Old Type 6. 9.None	1.Poor 4.Avg 7.V G
SF Masonry Trim 0	# Rooms 0	2.Fair 5.Avg+ 8.Exc
SEPTIC DESIGN 0	# Bedrooms 0	3.Avg- 6.Good 9.Same
BLDG PERMIT 0	# Full Baths 0	Phys. % Good 0%
Year Built 0	# Half Baths 0	Funct. % Good 100%
Year Remodeled 0	# Addn Fixtures 0	Functional Code 9 None
Foundation 0	# Fireplaces 0	1.Incomp 4.Delap 7.No Power
1.Concrete 4.Wood 7.		2.O-Built 5.Bsmt 8.LongTerm
2.C Block 5.Slab 8.		3.Damage 6.Dbwd 9.None
3.Br/Stone 6.Piers 9.		Econ. % Good 100%
Basement 0		Economic Code None
1.1/4 Bmt 4.Full Bmt 7.		0.None 3.No Power 7.
2.1/2 Bmt 5.None 8.		1.Location 4.Generate 8.
3.3/4 Bmt 6. 9.None		2.Encroach 9.None 9.
Bsmt Gar # Cars 0		Entrance Code 0
Wet Basement 0		1.Interior 4.Vacant 7.Entered
1.Dry 4. 7.		2.Refusal 5.Estimate 8.No
2.Damp 5. 8.		3.Informed 6.Reviewed 9.Land
3.Wet 6. 9.		Information Code 0
		1.Owner 4.Agent 7.
		2.Relative 5.Estimate 8.
		3.Tenant 6.Other 9.



Date Inspected

Additions, Outbuildings & Improvements								
Type	Year	Units	Grade	Cond	Phys.	Funct.	Sound Value	
					%	%		1.One Story Fram
					%	%		2.Two Story Fram
					%	%		3.Three Story Fr
					%	%		4.1 & 1/2 Story
					%	%		5.1 & 3/4 Story
					%	%		6.2 & 1/2 Story
					%	%		21.Open Frame Por
					%	%		22.Encl Frame Por
					%	%		23.Attached Garag
					%	%		24.Frame Shed
					%	%		25.Frame Bay Wind
					%	%		26.1SFr Overhang
					%	%		27.Unfin Basement
					%	%		28.Unfinished Att
					%	%		29.Finished Attic

MASHL, ANDRIA G
 BYRAS, STEPHANIE A
 749 LEWIS HILL RD
 BOWDOIN ME 04287

B1663P324 B2769P202

Previous Owner
 GILZOW, ARTHUR
 MASHL, ANDREA G & BYRAS, STEPHANIE
 749 LEWIS HILL RD
 BOWDOIN ME 04287
 Sale Date: 9/18/2006

Inspection Witnessed By:

X	Date
No./Date	Description
	Date Insp.

Notes:

Bowdoin

Property Data			Assessment Record						
Neighborhood 11 Map 11			Year	Land	Buildings	Exempt	Total		
Tree Growth Year 0			2009	51,560	87,920	10,000	129,480		
Farmland Yr 0			2010	51,560	87,920	10,000	129,480		
Open Space Yr 0			2011	51,560	87,920	10,000	129,480		
Zone/Land Use 11 Residential 1			2012	51,560	87,920	10,000	129,480		
Secondary Zone			2013	51,560	87,920	10,000	129,480		
Topography			2014	51,560	87,920	10,000	129,480		
1.Level 4.Below St 7.LevelBog			2015	51,560	87,920	10,000	129,480		
2.Rolling 5.Low 8.Conform			2016	51,560	87,920	15,000	124,480		
3.Above St 6.FZone 9.Non-Confor			2017	51,560	87,920	20,000	119,480		
Utilities			2018	51,560	87,920	20,000	119,480		
1.Public 4.Dr Well 7.Cesspool			2019	51,560	87,920	20,000	119,480		
2.Water 5.Dug Well 8.			2020	51,560	87,920	25,000	114,480		
3.Sewer 6.Septic 9.None			2021	51,560	87,920	25,000	114,480		
Street 1 Paved			2022	51,560	80,940	21,500	111,000		
1.Paved 4.Proposed 7.MHG			Land Data						
2.Semi Imp 5.R/O/W 8.DIS			Front Foot	Type	Effective		Influence		Influence Codes
3.Gravel 6.MHP 9.None					Frontage	Depth	Factor	Code	
TG PLAN YEAR 0			11.Road Frontage					1.Unimproved	
Tif District # 0			12.Delta Triangle					2.Excess Frtg	
Sale Data			13.Nabla Triangle					3.Topography	
Sale Date 9/18/2006			14.Rear Land					4.Size/Shape	
Price			15.Miscellaneous					5.Access	
Sale Type 2 Land & Buildings								6.Restriction	
1.Land 4.Mobile 7.C/I L&B								7.Open Space	
2.L & B 5.Other 8.			Square Foot	Square Feet				8.View/Environ	
3.Building 6.C/I Land 9.			16.Regular Lot					9.Fract Share	
Financing 1 Conventional			17.Secondary Lot					Acres	
1.Convent 4.Seller 7.			18.Hydro Facility					30.Rear Land 3	
2.FHA/VA 5.Private 8.			19.Improvements					31.Tillable	
3.Assumed 6.Cash 9.Unknown			20.Base 3 (Fract)					32.Pasture	
Validity 2 Related Parties								33.Orchard	
1.Valid 4.Split 7.Renovate			Fract. Acre	Acres/Sites				34.Softwood F&O	
2.Related 5.Partial 8.Other			21.Base 1 (Fract)	24	1.00	100	%	0	
3.Distress 6.Exempt 9.Short			22.Base 2 (Fract)	28	2.90	100	%	0	
Verified 1 Buyer			23.Base 3	44	1.00	100	%	0	
1.Buyer 4.Agent 7.Family			Acres						
2.Seller 5.Pub Rec 8.Other			24.Base 1						
3.Lender 6.MLS 9.			25.Base 2						
			26.Frontage 1						
			27.Rear Land 4						
			28.Rear Land 1						
			29.Rear Land 2						
			Total Acreage		3.90				
								44.Lot Improvemen	
								45.Subdivision Lo	
								46.Golf Course	

Bowdoin

Map Lot 11-13-0

Account 1176

Location 749 LEWIS HILL RD

Card 1 Of 1 7/22/2022

Building Style 3 Raised Ranch	SF Bsmt Living 980	Layout 1 Typical
0.Not Code 4.Cape 8.Log	Fin Bsmt Grade 3 0	1.Typical 4. 7.
1.Conv. 5.Garrison 9.Other	OCCUPANCY 0	2.Inadeq 5. 8.
2.Ranch 6.Split 10.DW	Heat Type 100% 5 Forced Warm Air	3.Poor 6. 9.
3.R Ranch 7.Contemp 11.Church	0.Not Code 4.Steam 8.F/Wall	Attic 9 None
Dwelling Units 1	1.HWBB 5.FWA 9.No Heat	1.1/4 Fin 4.Full Fin 7.
Other Units 0	2.HWCI 6.GravWA 11.	2.1/2 Fin 5.F/Stair 8.
Stories 1 One Story	3.H Pump 7.Electric 12.	3.3/4 Fin 6. 9.None
1.1 4.1.5 7.4	Cool Type 0% 9 None	Insulation 1 Full
2.2 5.1.75 8.20	1.Refrig 4.W&C Air 7.	1.Full 4.Minimal 7.
3.3 6.2.5 9.Yurt	2.Evapor 5. 8.	2.Heavy 5. 8.
Exterior Walls 2 Vinyl/Aluminum	3.H Pump 6. 9.None	3.Capped 6. 9.None
0.Not Code 4.Asbestos 8.Concrete	Kitchen Style 2 Typical	Unfinished % 0%
1.Wood 5.Stucco 9.Other	1.Modern 4.Obsolete 7.	Grade & Factor 3 Average 100%
2.Vin/Al 6.Brick 10.Board B	2.Typical 5. 8.	1.E Grade 4.B Grade 7.
3.Compos. 7.Stone 12.	3.Old Type 6. 9.None	2.D Grade 5.A Grade 8.
Roof Surface 1 Asphalt Shingles	Bath(s) Style 2 Typical Bath(s)	3.C Grade 6.AA Grade 9.Same
1.Asphalt 4.Composit 7.	1.Modern 4.Obsolete 7.	SQFT (Footprint) 1092
2.Slate 5.Wood 8.	2.Typical 5. 8.	Condition 3 Below Average
3.Metal 6.Other 9.	3.Old Type 6. 9.None	1.Poor 4.Avg 7.V G
SF Masonry Trim 0	# Rooms 7	2.Fair 5.Avg+ 8.Exc
SEPTIC DESIGN 0	# Bedrooms 3	3.Avg- 6.Good 9.Same
BLDG PERMIT 0	# Full Baths 1	Phys. % Good 0%
Year Built 1976	# Half Baths 1	Funct. % Good 100%
Year Remodeled 0	# Addn Fixtures 0	Functional Code 9 None
Foundation 1 Concrete	# Fireplaces 0	1.Incomp 4.Delap 7.No Power
1.Concrete 4.Wood 7.	 <p>TRIO Software A Division of Harris Computer Systems</p>	2.O-Built 5.Bsmt 8.LongTerm
2.C Block 5.Slab 8.		3.Damage 6.Dbwd 9.None
3.Br/Stone 6.Piers 9.		Econ. % Good 100%
Basement 4 Full Basement		Economic Code None
1.1/4 Bmt 4.Full Bmt 7.		0.None 3.No Power 7.
2.1/2 Bmt 5.None 8.		1.Location 4.Generate 8.
3.3/4 Bmt 6. 9.None		2.Encroach 9.None 9.
Bsmt Gar # Cars 0		Entrance Code 5 Estimated
Wet Basement 1 Dry Basement		1.Interior 4.Vacant 7.Entered
1.Dry 4. 7.		2.Refusal 5.Estimate 8.No
2.Damp 5. 8.	3.Informed 6.Reviewed 9.Land	
3.Wet 6. 9.	Information Code 5 Estimate	
	1.Owner 4.Agent 7.	
	2.Relative 5.Estimate 8.	
	3.Tenant 6.Other 9.	

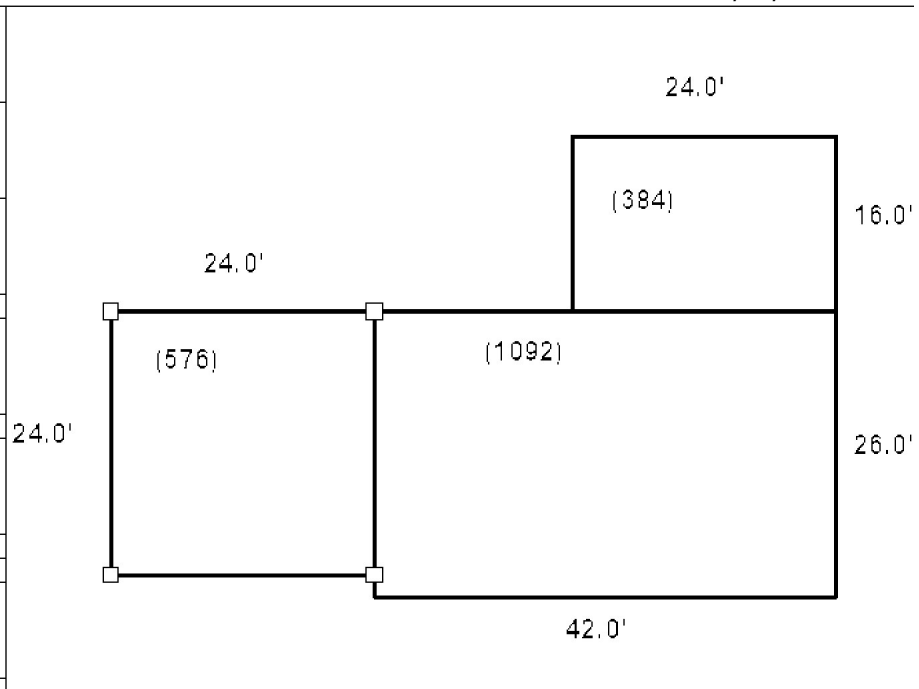

Date Inspected

Additions, Outbuildings & Improvements

Type	Year	Units	Grade	Cond	Phys.	Funct.	Sound Value
23 Attached Garage	1976	576	0 0	0	0 %	0 %	
68 Wood Deck	0	384	0 0	0	0 %	0 %	
					%	%	
					%	%	
					%	%	
					%	%	
					%	%	
					%	%	
					%	%	
					%	%	
					%	%	
					%	%	



- 1.One Story Fram
- 2.Two Story Fram
- 3.Three Story Fr
- 4.1 & 1/2 Story
- 5.1 & 3/4 Story
- 6.2 & 1/2 Story
- 21.Open Frame Por
- 22.Encl Frame Por
- 23.Attached Garag
- 24.Frame Shed
- 25.Frame Bay Wind
- 26.1SFr Overhang
- 27.Unfin Basement
- 28.Unfinished Att
- 29.Finished Attic

CONKLING, ISABELLE N
759 LEWIS HILL RD
BOWDOIN ME 04287

B2015RP3688 B2446P184 B3283P346

Previous Owner
McDONNELL, LAURIE E
MCDONNELL THOMAS F
759 LEWIS HILL RD
BOWDOIN ME 04287
Sale Date: 6/02/2015

Previous Owner
McDONNELL, LAURIE & LISA BLAKE
McDONNELL, THOMAS
P.O. BOX 123
BOWDOINHAM ME 04008
Sale Date: 2/22/2011

Previous Owner
McDONNELL, LAURIE & LISA BLAKE
McDONNELL, THOMAS
759 LEWIS HILL RD
BOWDOIN ME 04287
Sale Date: 2/22/2011

Inspection Witnessed By:

X	Date
No./Date	Description
	Date Insp.

Notes:

Bowdoin

Property Data			Assessment Record						
Neighborhood 11 Map 11			Year	Land	Buildings	Exempt	Total		
Tree Growth Year 0			2009	64,300	152,730	10,000	207,030		
Farmland Yr 0			2010	64,300	152,730	10,000	207,030		
Open Space Yr 0			2011	64,300	152,730	10,000	207,030		
Zone/Land Use 11 Residential 1			2012	64,300	152,730	10,000	207,030		
Secondary Zone			2013	64,300	152,730	10,000	207,030		
Topography			2014	64,300	152,730	10,000	207,030		
1.Level 4.Below St 7.LevelBog			2015	64,300	152,730	0	217,030		
2.Rolling 5.Low 8.Conform			2016	64,300	152,730	0	217,030		
3.Above St 6.FZone 9.Non-Confor			2017	64,300	152,730	0	217,030		
Utilities			2018	64,300	132,930	20,000	177,230		
1.Public 4.Dr Well 7.Cesspool			2019	64,300	132,930	20,000	177,230		
2.Water 5.Dug Well 8.			2020	64,300	132,930	25,000	172,230		
3.Sewer 6.Septic 9.None			2021	64,300	140,530	25,000	179,830		
Street 1 Paved			2022	64,300	137,440	21,500	180,240		
1.Paved 4.Proposed 7.MHG			Land Data						
2.Semi Imp 5.R/O/W 8.DIS									
3.Gravel 6.MHP 9.None			Front Foot	Type	Effective		Influence		Influence Codes
TG PLAN YEAR 0			11.Road Frontage		Frontage	Depth	Factor	Code	
Tif District # 0			12.Delta Triangle				%		1.Unimproved
Sale Data			13.Nabla Triangle				%		2.Excess Frtg
Sale Date 6/02/2015			14.Rear Land				%		3.Topography
Price 270,000			15.Miscellaneous				%		4.Size/Shape
Sale Type 2 Land & Buildings							%		5.Access
1.Land 4.Mobile 7.C/I L&B							%		6.Restriction
2.L & B 5.Other 8.			Square Foot	Square Feet					7.Open Space
3.Building 6.C/I Land 9.			16.Regular Lot				%		8.View/Environ
Financing 9 Unknown			17.Secondary Lot				%		9.Fract Share
1.Convent 4.Seller 7.			18.Hydro Facility				%		Acres
2.FHA/VA 5.Private 8.			19.Improvements				%		30.Rear Land 3
3.Assumed 6.Cash 9.Unknown			20.Base 3 (Fract)				%		31.Tillable
Validity 1 Arms Length Sale							%		32.Pasture
1.Valid 4.Split 7.Renovate			Fract. Acre	Acres/Sites					33.Orchard
2.Related 5.Partial 8.Other			21.Base 1 (Fract)	24	1.00	100	%	0	34.Softwood F&O
3.Distress 6.Exempt 9.Short			22.Base 2 (Fract)	28	12.00	100	%	0	35.Mixed Wood F&O
Verified 5 Public Record			23.Base 3	44	1.00	100	%	0	36.Hardwood F&O
1.Buyer 4.Agent 7.Family			Acres				%		37.Softwood TG
2.Seller 5.Pub Rec 8.Other			24.Base 1				%		38.Mixed Wood TG
3.Lender 6.MLS 9.			25.Base 2				%		39.Hardwood TG
			26.Frontage 1				%		40.Wasteland
			27.Rear Land 4				%		41.Commercial
			28.Rear Land 1				%		42.2nd Site
			29.Rear Land 2				%		43.Post Rd
			Total Acreage		13.00				44.Lot Improvemen
									45.Subdivision Lo
									46.Golf Course

Bowdoin

Map Lot 11-13-01

Account 1177

Location 759 LEWIS HILL RD

Card 1 Of 1 7/22/2022

Building Style 4 Cape Cod	SF Bsmt Living 0	Layout 1 Typical
0.Not Code 4.Cape 8.Log	Fin Bsmt Grade 0 0	1.Typical 4. 7.
1.Conv. 5.Garrison 9.Other	OCCUPANCY 0	2.Inadeq 5. 8.
2.Ranch 6.Split 10.DW	Heat Type 100% 1 Hot Water BB	3.Poor 6. 9.
3.R Ranch 7.Contemp 11.Church	0.Not Code 4.Steam 8.FI/Wall	Attic 9 None
Dwelling Units 1	1.HWBB 5.FWA 9.No Heat	1.1/4 Fin 4.Full Fin 7.
Other Units 0	2.HWCI 6.GravWA 11.	2.1/2 Fin 5.FI/Stair 8.
Stories 4 One & 1/2 Story	3.H Pump 7.Electric 12.	3.3/4 Fin 6. 9.None
1.1 4.1.5 7.4	Cool Type 0% 9 None	Insulation 1 Full
2.2 5.1.75 8.20	1.Refrig 4.W&C Air 7.	1.Full 4.Minimal 7.
3.3 6.2.5 9.Yurt	2.Evapor 5. 8.	2.Heavy 5. 8.
Exterior Walls 2 Vinyl/Aluminum	3.H Pump 6. 9.None	3.Capped 6. 9.None
0.Not Code 4.Asbestos 8.Concrete	Kitchen Style 2 Typical	Unfinished % 0%
1.Wood 5.Stucco 9.Other	1.Modern 4.Obsolete 7.	Grade & Factor 3 Average 105%
2.Vin/Al 6.Brick 10.Board B	2.Typical 5. 8.	1.E Grade 4.B Grade 7.
3.Compos. 7.Stone 12.	3.Old Type 6. 9.None	2.D Grade 5.A Grade 8.
Roof Surface 1 Asphalt Shingles	Bath(s) Style 2 Typical Bath(s)	3.C Grade 6.AA Grade 9.Same
1.Asphalt 4.Composit 7.	1.Modern 4.Obsolete 7.	SQFT (Footprint) 748
2.Slate 5.Wood 8.	2.Typical 5. 8.	Condition 4 Average
3.Metal 6.Other 9.	3.Old Type 6. 9.None	1.Poor 4.Avg 7.V G
SF Masonry Trim 0	# Rooms 8	2.Fair 5.Avg+ 8.Exc
SEPTIC DESIGN 0	# Bedrooms 3	3.Avg- 6.Good 9.Same
BLDG PERMIT 0	# Full Baths 2	Phys. % Good 0%
Year Built 1853	# Half Baths 1	Funct. % Good 100%
Year Remodeled 2007	# Addn Fixtures 0	Functional Code 9 None
Foundation 3 Brick &/or Stone	# Fireplaces 2	1.Incomp 4.Delap 7.No Power
1.Concrete 4.Wood 7.		2.O-Built 5.Bsmt 8.LongTerm
2.C Block 5.Slab 8.		3.Damage 6.Dbwd 9.None
3.Br/Stone 6.Piers 9.		Econ. % Good 100%
Basement 4 Full Basement		Economic Code None
1.1/4 Bmt 4.Full Bmt 7.		0.None 3.No Power 7.
2.1/2 Bmt 5.None 8.		1.Location 4.Generate 8.
3.3/4 Bmt 6. 9.None		2.Encroach 9.None 9.
Bsmt Gar # Cars 0		Entrance Code 3 Information Only
Wet Basement 3 Wet Basement		1.Interior 4.Vacant 7.Entered
1.Dry 4. 7.		2.Refusal 5.Estimate 8.No
2.Damp 5. 8.		3.Informed 6.Reviewed 9.Land
3.Wet 6. 9.		Information Code 2 Relative
		1.Owner 4.Agent 7.
		2.Relative 5.Estimate 8.
		3.Tenant 6.Other 9.



Date Inspected 4/22/2016

Additions, Outbuildings & Improvements

Type	Year	Units	Grade	Cond	Phys.	Funct.	Sound Value
1 One Story Frame	2007	168	3 100	4	0 %	100 %	
1 One Story Frame	2007	364	3 100	4	0 %	100 %	
1 One Story Frame	2007	224	3 100	4	0 %	100 %	
65 Barn	1984	1008	2 100	3	0 %	100 %	
63 Swimming Pool	2020	800	3 100	4	0 %	100 %	
					%	%	
					%	%	
					%	%	
					%	%	
					%	%	
					%	%	
					%	%	

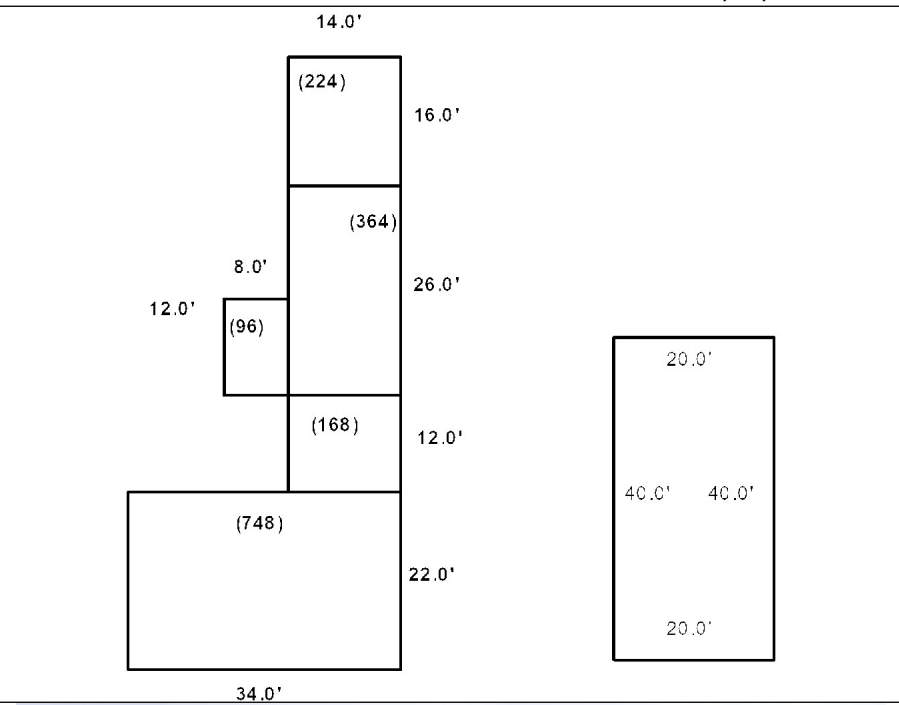

WEST, ROBERT P
780 LEWIS HILL RD
BOWDOIN ME 04287

B1076P177

Inspection Witnessed By:

X

Date

No./Date	Description	Date Insp.

Notes:

Bowdoin

Property Data			Assessment Record				
Neighborhood 11 Map 11			Year	Land	Buildings	Exempt	Total
Tree Growth Year 0			2009	98,500	47,240	10,000	135,740
Farmland Yr 0			2010	98,500	47,240	10,000	135,740
Open Space Yr 0			2011	98,500	47,240	10,000	135,740
Zone/Land Use 11 Residential 1			2012	98,500	47,240	10,000	135,740
Secondary Zone			2013	98,500	47,240	10,000	135,740
Topography			2014	98,500	47,240	10,000	135,740
1.Level 4.Below St 7.LevelBog			2015	98,500	47,240	10,000	135,740
2.Rolling 5.Low 8.Conform			2016	98,500	47,240	15,000	130,740
3.Above St 6.FZone 9.Non-Confor			2017	98,500	47,240	20,000	125,740
Utilities			2018	98,500	47,240	20,000	125,740
1.Public 4.Dr Well 7.Cesspool			2019	98,500	47,240	20,000	125,740
2.Water 5.Dug Well 8.			2020	98,500	47,240	25,000	120,740
3.Sewer 6.Septic 9.None			2021	98,500	47,240	25,000	120,740
Street 1 Paved			2022	98,500	47,240	21,500	124,240
1.Paved 4.Proposed 7.MHG			Land Data				
2.Semi Imp 5.R/O/W 8.DIS							
3.Gravel 6.MHP 9.None			Front Foot				
TG PLAN YEAR 0							
Tif District # 0			Type				
Sale Data							
Sale Date			Effective				
Price							
Sale Type			Influence				
1.Land 4.Mobile 7.C/I L&B							
2.L & B 5.Other 8.			Influence Codes				
3.Building 6.C/I Land 9.							
Financing			Square Foot				
1.Convent 4.Seller 7.							
2.FHA/VA 5.Private 8.			Square Feet				
3.Assumed 6.Cash 9.Unknown							
Validity			Fract. Acre				
1.Valid 4.Split 7.Renovate							
2.Related 5.Partial 8.Other			Acres				
3.Distress 6.Exempt 9.Short							
Verified			Acres				
1.Buyer 4.Agent 7.Family							
2.Seller 5.Pub Rec 8.Other			Acres				
3.Lender 6.MLS 9.							

Type	Effective		Influence		Influence Codes
	Frontage	Depth	Factor	Code	
11.Road Frontage			%		1.Unimproved
12.Delta Triangle			%		2.Excess Frtg
13.Nabla Triangle			%		3.Topography
14.Rear Land			%		4.Size/Shape
15.Miscellaneous			%		5.Access
			%		6.Restriction
			%		7.Open Space
			%		8.View/Environ
			%		9.Fract Share
			%		Acres
			%		30.Rear Land 3
			%		31.Tillable
			%		32.Pasture
			%		33.Orchard
			%		34.Softwood F&O
			%		35.Mixed Wood F&O
24	1.00	100	%	0	36.Hardwood F&O
26	4.00	100	%	0	37.Softwood TG
28	25.00	100	%	0	38.Mixed Wood TG
29	4.00	100	%	0	39.Hardwood TG
44	1.00	100	%	0	40.Wasteland
			%		41.Commercial
			%		42.2nd Site
			%		43.Post Rd
			%		44.Lot Improvemen
			%		45.Subdivision Lo
			%		46.Golf Course
Total Acreage		34.00			

WEST, ROBERT P
780 LEWIS HILL RD
BOWDOIN ME 04287

B1076P177

Inspection Witnessed By:

X		Date
No./Date	Description	Date Insp.

Notes:

Bowdoin

Property Data			Assessment Record				
Neighborhood 11 Map 11			Year	Land	Buildings	Exempt	Total
Tree Growth Year 0			2009	49,600	30,770	0	80,370
Farmland Yr 0			2010	49,600	30,770	0	80,370
Open Space Yr 0			2011	49,600	30,770	0	80,370
Zone/Land Use 11 Residential 1			2012	49,600	30,770	0	80,370
Secondary Zone			2013	49,600	30,770	0	80,370
Topography			2014	49,600	30,770	0	80,370
1.Level 4.Below St 7.LevelBog			2015	49,600	30,770	0	80,370
2.Rolling 5.Low 8.Conform			2016	49,600	30,770	0	80,370
3.Above St 6.FZone 9.Non-Confor			2017	49,600	30,770	0	80,370
Utilities			2018	49,600	30,770	0	80,370
1.Public 4.Dr Well 7.Cesspool			2019	49,600	30,770	0	80,370
2.Water 5.Dug Well 8.			2020	49,600	30,770	0	80,370
3.Sewer 6.Septic 9.None			2021	49,600	30,770	0	80,370
Street 1 Paved			2022	49,600	30,020	0	79,620
1.Paved 4.Proposed 7.MHG			Land Data				
2.Semi Imp 5.R/O/W 8.DIS							
3.Gravel 6.MHP 9.None			Front Foot				
TG PLAN YEAR 0							
Tif District # 0			Type				
Sale Data							
Sale Date			Effective				
Price							
Sale Type			Influence				
1.Land 4.Mobile 7.C/I L&B							
2.L & B 5.Other 8.			Influence Codes				
3.Building 6.C/I Land 9.							
Financing			Square Foot				
1.Convent 4.Seller 7.							
2.FHA/VA 5.Private 8.			Square Feet				
3.Assumed 6.Cash 9.Unknown							
Validity			Fract. Acre				
1.Valid 4.Split 7.Renovate							
2.Related 5.Partial 8.Other			Acres				
3.Distress 6.Exempt 9.Short							
Verified			Acres				
1.Buyer 4.Agent 7.Family							
2.Seller 5.Pub Rec 8.Other			Total Acreage 2.50				
3.Lender 6.MLS 9.							

- 1.Unimproved
- 2.Excess Frtg
- 3.Topography
- 4.Size/Shape
- 5.Access
- 6.Restriction
- 7.Open Space
- 8.View/Environ
- 9.Fract Share
- Acres**
- 30.Rear Land 3
- 31.Tillable
- 32.Pasture
- 33.Orchard
- 34.Softwood F&O
- 35.Mixed Wood F&O
- 36.Hardwood F&O
- 37.Softwood TG
- 38.Mixed Wood TG
- 39.Hardwood TG
- 40.Wasteland
- 41.Commercial
- 42.2nd Site
- 43.Post Rd
- 44.Lot Improvemen
- 45.Subdivision Lo
- 46.Golf Course

SMALL, DANA W & ELDELIA M
WEST, GREGORY
811 LEWIS HILL RD
BOWDOIN ME 04287

B1859P244 B2014RP405

Property Data			Assessment Record																																																																																																																																																																																																																	
			Year	Land	Buildings	Exempt	Total																																																																																																																																																																																																													
Neighborhood 11 Map 11			2009	110,400	95,270	16,000	189,670																																																																																																																																																																																																													
Tree Growth Year 0			2010	110,400	95,270	16,000	189,670																																																																																																																																																																																																													
Farmland Yr 0			2011	110,400	95,270	16,000	189,670																																																																																																																																																																																																													
Open Space Yr 2005			2012	110,400	95,270	16,000	189,670																																																																																																																																																																																																													
Zone/Land Use 11 Residential 1			2013	110,400	95,270	16,000	189,670																																																																																																																																																																																																													
Secondary Zone			2014	110,400	95,270	16,000	189,670																																																																																																																																																																																																													
Topography 6 Flood Zone			2015	110,400	95,270	16,000	189,670																																																																																																																																																																																																													
1.Level 4.Below St 7.LevelBog			2016	110,400	95,270	21,000	184,670																																																																																																																																																																																																													
2.Rolling 5.Low 8.Conform			2017	110,400	95,270	26,000	179,670																																																																																																																																																																																																													
3.Above St 6.FZone 9.Non-Confor			2018	110,400	95,270	26,000	179,670																																																																																																																																																																																																													
Utilities			2019	110,400	95,270	26,000	179,670																																																																																																																																																																																																													
1.Public 4.Dr Well 7.Cesspool			2020	110,400	95,270	31,000	174,670																																																																																																																																																																																																													
2.Water 5.Dug Well 8.			2021	110,400	95,270	31,000	174,670																																																																																																																																																																																																													
3.Sewer 6.Septic 9.None			2022	110,400	93,910	26,660	177,650																																																																																																																																																																																																													
Street 1 Paved			<table border="1"> <thead> <tr> <th colspan="5">Land Data</th> </tr> <tr> <th rowspan="2">Front Foot</th> <th rowspan="2">Type</th> <th colspan="2">Effective</th> <th colspan="2">Influence</th> <th rowspan="2">Influence Codes</th> </tr> <tr> <th>Frontage</th> <th>Depth</th> <th>Factor</th> <th>Code</th> </tr> </thead> <tbody> <tr> <td>11.Road Frontage</td> <td></td> <td></td> <td></td> <td>%</td> <td></td> <td>1.Unimproved</td> </tr> <tr> <td>12.Delta Triangle</td> <td></td> <td></td> <td></td> <td>%</td> <td></td> <td>2.Excess Frtg</td> </tr> <tr> <td>13.Nabla Triangle</td> <td></td> <td></td> <td></td> <td>%</td> <td></td> <td>3.Topography</td> </tr> <tr> <td>14.Rear Land</td> <td></td> <td></td> <td></td> <td>%</td> <td></td> <td>4.Size/Shape</td> </tr> <tr> <td>15.Miscellaneous</td> <td></td> <td></td> <td></td> <td>%</td> <td></td> <td>5.Access</td> </tr> <tr> <td></td> <td></td> <td></td> <td></td> <td>%</td> <td></td> <td>6.Restriction</td> </tr> <tr> <td></td> <td></td> <td></td> <td></td> <td>%</td> <td></td> <td>7.Open Space</td> </tr> <tr> <td></td> <td></td> <td></td> <td></td> <td>%</td> <td></td> <td>8.View/Environ</td> </tr> <tr> <td></td> <td></td> <td></td> <td></td> <td>%</td> <td></td> <td>9.Fract Share</td> </tr> <tr> <td></td> <td></td> <td></td> <td></td> <td>%</td> <td></td> <td>Acres</td> </tr> <tr> <td></td> <td></td> <td></td> <td></td> <td>%</td> <td></td> <td>30.Rear Land 3</td> </tr> <tr> <td></td> <td></td> <td></td> <td></td> <td>%</td> <td></td> <td>31.Tillable</td> </tr> <tr> <td></td> <td></td> <td></td> <td></td> <td>%</td> <td></td> <td>32.Pasture</td> </tr> <tr> <td></td> <td></td> <td></td> <td></td> <td>%</td> <td></td> <td>33.Orchard</td> </tr> <tr> <td></td> <td></td> <td></td> <td></td> <td>%</td> <td></td> <td>34.Softwood F&O</td> </tr> <tr> <td></td> <td></td> <td></td> <td></td> <td>%</td> <td></td> <td>35.Mixed Wood F&O</td> </tr> <tr> <td></td> <td></td> <td></td> <td></td> <td>%</td> <td></td> <td>36.Hardwood F&O</td> </tr> <tr> <td></td> <td></td> <td></td> <td></td> <td>%</td> <td></td> <td>37.Softwood TG</td> </tr> <tr> <td></td> <td></td> <td></td> <td></td> <td>%</td> <td></td> <td>38.Mixed Wood TG</td> </tr> <tr> <td></td> <td></td> <td></td> <td></td> <td>%</td> <td></td> <td>39.Hardwood TG</td> </tr> <tr> <td></td> <td></td> <td></td> <td></td> <td>%</td> <td></td> <td>40.Wasteland</td> </tr> <tr> <td></td> <td></td> <td></td> <td></td> <td>%</td> <td></td> <td>41.Commercial</td> </tr> <tr> <td></td> <td></td> <td></td> <td></td> <td>%</td> <td></td> <td>42.2nd Site</td> </tr> <tr> <td></td> <td></td> <td></td> <td></td> <td>%</td> <td></td> <td>43.Post Rd</td> </tr> <tr> <td></td> <td></td> <td></td> <td></td> <td>%</td> <td></td> <td>44.Lot Improvemen</td> </tr> <tr> <td></td> <td></td> <td></td> <td></td> <td>%</td> <td></td> <td>45.Subdivision Lo</td> </tr> <tr> <td></td> <td></td> <td></td> <td></td> <td>%</td> <td></td> <td>46.Golf Course</td> </tr> </tbody> </table>					Land Data					Front Foot	Type	Effective		Influence		Influence Codes	Frontage	Depth	Factor	Code	11.Road Frontage				%		1.Unimproved	12.Delta Triangle				%		2.Excess Frtg	13.Nabla Triangle				%		3.Topography	14.Rear Land				%		4.Size/Shape	15.Miscellaneous				%		5.Access					%		6.Restriction					%		7.Open Space					%		8.View/Environ					%		9.Fract Share					%		Acres					%		30.Rear Land 3					%		31.Tillable					%		32.Pasture					%		33.Orchard					%		34.Softwood F&O					%		35.Mixed Wood F&O					%		36.Hardwood F&O					%		37.Softwood TG					%		38.Mixed Wood TG					%		39.Hardwood TG					%		40.Wasteland					%		41.Commercial					%		42.2nd Site					%		43.Post Rd					%		44.Lot Improvemen					%		45.Subdivision Lo					%		46.Golf Course
Land Data																																																																																																																																																																																																																				
Front Foot	Type	Effective		Influence		Influence Codes																																																																																																																																																																																																														
		Frontage	Depth	Factor	Code																																																																																																																																																																																																															
11.Road Frontage				%		1.Unimproved																																																																																																																																																																																																														
12.Delta Triangle				%		2.Excess Frtg																																																																																																																																																																																																														
13.Nabla Triangle				%		3.Topography																																																																																																																																																																																																														
14.Rear Land				%		4.Size/Shape																																																																																																																																																																																																														
15.Miscellaneous				%		5.Access																																																																																																																																																																																																														
				%		6.Restriction																																																																																																																																																																																																														
				%		7.Open Space																																																																																																																																																																																																														
				%		8.View/Environ																																																																																																																																																																																																														
				%		9.Fract Share																																																																																																																																																																																																														
				%		Acres																																																																																																																																																																																																														
				%		30.Rear Land 3																																																																																																																																																																																																														
				%		31.Tillable																																																																																																																																																																																																														
				%		32.Pasture																																																																																																																																																																																																														
				%		33.Orchard																																																																																																																																																																																																														
				%		34.Softwood F&O																																																																																																																																																																																																														
				%		35.Mixed Wood F&O																																																																																																																																																																																																														
				%		36.Hardwood F&O																																																																																																																																																																																																														
				%		37.Softwood TG																																																																																																																																																																																																														
				%		38.Mixed Wood TG																																																																																																																																																																																																														
				%		39.Hardwood TG																																																																																																																																																																																																														
				%		40.Wasteland																																																																																																																																																																																																														
				%		41.Commercial																																																																																																																																																																																																														
				%		42.2nd Site																																																																																																																																																																																																														
				%		43.Post Rd																																																																																																																																																																																																														
				%		44.Lot Improvemen																																																																																																																																																																																																														
				%		45.Subdivision Lo																																																																																																																																																																																																														
				%		46.Golf Course																																																																																																																																																																																																														
TG PLAN YEAR 0			<table border="1"> <thead> <tr> <th>Front Foot</th> <th colspan="2">Square Feet</th> <th colspan="2">Acres/Sites</th> <th></th> </tr> </thead> <tbody> <tr> <td>24</td> <td>1.00</td> <td>100</td> <td>%</td> <td>0</td> <td></td> </tr> <tr> <td>26</td> <td>1.00</td> <td>100</td> <td>%</td> <td>0</td> <td></td> </tr> <tr> <td>28</td> <td>25.00</td> <td>80</td> <td>%</td> <td>7</td> <td></td> </tr> <tr> <td>29</td> <td>25.00</td> <td>80</td> <td>%</td> <td>7</td> <td></td> </tr> <tr> <td>44</td> <td>1.00</td> <td>100</td> <td>%</td> <td>0</td> <td></td> </tr> <tr> <td>30</td> <td>17.00</td> <td>100</td> <td>%</td> <td>0</td> <td></td> </tr> <tr> <td colspan="2">Total Acreage</td> <td>69.00</td> <td colspan="3"></td> </tr> </tbody> </table>					Front Foot	Square Feet		Acres/Sites			24	1.00	100	%	0		26	1.00	100	%	0		28	25.00	80	%	7		29	25.00	80	%	7		44	1.00	100	%	0		30	17.00	100	%	0		Total Acreage		69.00																																																																																																																																																																
Front Foot	Square Feet							Acres/Sites																																																																																																																																																																																																												
24	1.00	100	%	0																																																																																																																																																																																																																
26	1.00	100	%	0																																																																																																																																																																																																																
28	25.00	80	%	7																																																																																																																																																																																																																
29	25.00	80	%	7																																																																																																																																																																																																																
44	1.00	100	%	0																																																																																																																																																																																																																
30	17.00	100	%	0																																																																																																																																																																																																																
Total Acreage		69.00																																																																																																																																																																																																																		
Tif District # 0																																																																																																																																																																																																																				
Sale Data																																																																																																																																																																																																																				
Sale Date 10/28/2014																																																																																																																																																																																																																				
Price																																																																																																																																																																																																																				
Sale Type 2 Land & Buildings																																																																																																																																																																																																																				
1.Land 4.Mobile 7.C/I L&B																																																																																																																																																																																																																				
2.L & B 5.Other 8.																																																																																																																																																																																																																				
3.Building 6.C/I Land 9.																																																																																																																																																																																																																				
Financing 9 Unknown																																																																																																																																																																																																																				
1.Convent 4.Seller 7.																																																																																																																																																																																																																				
2.FHA/VA 5.Private 8.																																																																																																																																																																																																																				
3.Assumed 6.Cash 9.Unknown																																																																																																																																																																																																																				
Validity 2 Related Parties																																																																																																																																																																																																																				
1.Valid 4.Split 7.Renovate																																																																																																																																																																																																																				
2.Related 5.Partial 8.Other																																																																																																																																																																																																																				
3.Distress 6.Exempt 9.Short																																																																																																																																																																																																																				
Verified 5 Public Record																																																																																																																																																																																																																				
1.Buyer 4.Agent 7.Family																																																																																																																																																																																																																				
2.Seller 5.Pub Rec 8.Other																																																																																																																																																																																																																				
3.Lender 6.MLS 9.																																																																																																																																																																																																																				

Inspection Witnessed By:

X	Date	Date Insp.
No./Date	Description	Date Insp.

Notes:

Bowdoin

Bowdoin

Map Lot 11-16-0

Account 1181

Location 811 LEWIS HILL RD

Card 1

Of 1

7/22/2022

Building Style 4 Cape Cod	SF Bsmt Living 0	Layout 1 Typical
0.Not Code 4.Cape 8.Log	Fin Bsmt Grade 0 0	1.Typical 4. 7.
1.Conv. 5.Garrison 9.Other	OCCUPANCY 0	2.Inadeq 5. 8.
2.Ranch 6.Split 10.DW	Heat Type 100% 5 Forced Warm Air	3.Poor 6. 9.
3.R Ranch 7.Contemp 11.Church	0.Not Code 4.Steam 8.FI/Wall	Attic 9 None
Dwelling Units 1	1.HWBB 5.FWA 9.No Heat	1.1/4 Fin 4.Full Fin 7.
Other Units 0	2.HWCI 6.GravWA 11.	2.1/2 Fin 5.FI/Stair 8.
Stories 4 One & 1/2 Story	3.H Pump 7.Electric 12.	3.3/4 Fin 6. 9.None
1.1 4.1.5 7.4	Cool Type 0% 9 None	Insulation 1 Full
2.2 5.1.75 8.20	1.Refrig 4.W&C Air 7.	1.Full 4.Minimal 7.
3.3 6.2.5 9.Yurt	2.Evapor 5. 8.	2.Heavy 5. 8.
Exterior Walls 2 Vinyl/Aluminum	3.H Pump 6. 9.None	3.Capped 6. 9.None
0.Not Code 4.Asbestos 8.Concrete	Kitchen Style 2 Typical	Unfinished % 0%
1.Wood 5.Stucco 9.Other	1.Modern 4.Obsolete 7.	Grade & Factor 3 Average 110%
2.Vin/Al 6.Brick 10.Board B	2.Typical 5. 8.	1.E Grade 4.B Grade 7.
3.Compos. 7.Stone 12.	3.Old Type 6. 9.None	2.D Grade 5.A Grade 8.
Roof Surface 1 Asphalt Shingles	Bath(s) Style 2 Typical Bath(s)	3.C Grade 6.AA Grade 9.Same
1.Asphalt 4.Composit 7.	1.Modern 4.Obsolete 7.	SQFT (Footprint) 1008
2.Slate 5.Wood 8.	2.Typical 5. 8.	Condition 3 Below Average
3.Metal 6.Other 9.	3.Old Type 6. 9.None	1.Poor 4.Avg 7.V G
SF Masonry Trim 0	# Rooms 8	2.Fair 5.Avg+ 8.Exc
SEPTIC DESIGN 0	# Bedrooms 5	3.Avg- 6.Good 9.Same
BLDG PERMIT 0	# Full Baths 1	Phys. % Good 0%
Year Built 1880	# Half Baths 1	Funct. % Good 100%
Year Remodeled 1940	# Addn Fixtures 0	Functional Code 9 None
Foundation 3 Brick &/or Stone	# Fireplaces 0	1.Incomp 4.Delap 7.No Power
1.Concrete 4.Wood 7.		2.O-Built 5.Bsmt 8.LongTerm
2.C Block 5.Slab 8.		3.Damage 6.Dbwd 9.None
3.Br/Stone 6.Piers 9.		Econ. % Good 100%
Basement 4 Full Basement		Economic Code None
1.1/4 Bmt 4.Full Bmt 7.		0.None 3.No Power 7.
2.1/2 Bmt 5.None 8.		1.Location 4.Generate 8.
3.3/4 Bmt 6. 9.None		2.Encroach 9.None 9.
Bsmt Gar # Cars 0		Entrance Code 5 Estimated
Wet Basement 2 Damp Basement		1.Interior 4.Vacant 7.Entered
1.Dry 4. 7.		2.Refusal 5.Estimate 8.No
2.Damp 5. 8.	3.Informed 6.Reviewed 9.Land	
3.Wet 6. 9.	Information Code 5 Estimate	
	1.Owner 4.Agent 7.	
	2.Relative 5.Estimate 8.	
	3.Tenant 6.Other 9.	

Date Inspected

Additions, Outbuildings & Improvements

Type	Year	Units	Grade	Cond	Phys.	Funct.	Sound Value
24 Frame Shed	0	360	0 0	0	0 %	0 %	
21 Open Frame	0	78	0 0	0	0 %	0 %	
65 Barn	0	1800	2 100	2	0 %	100 %	
30 Detached Garage	1980	768	3 100	3	0 %	100 %	
					%	%	
					%	%	
					%	%	
					%	%	
					%	%	
					%	%	
					%	%	

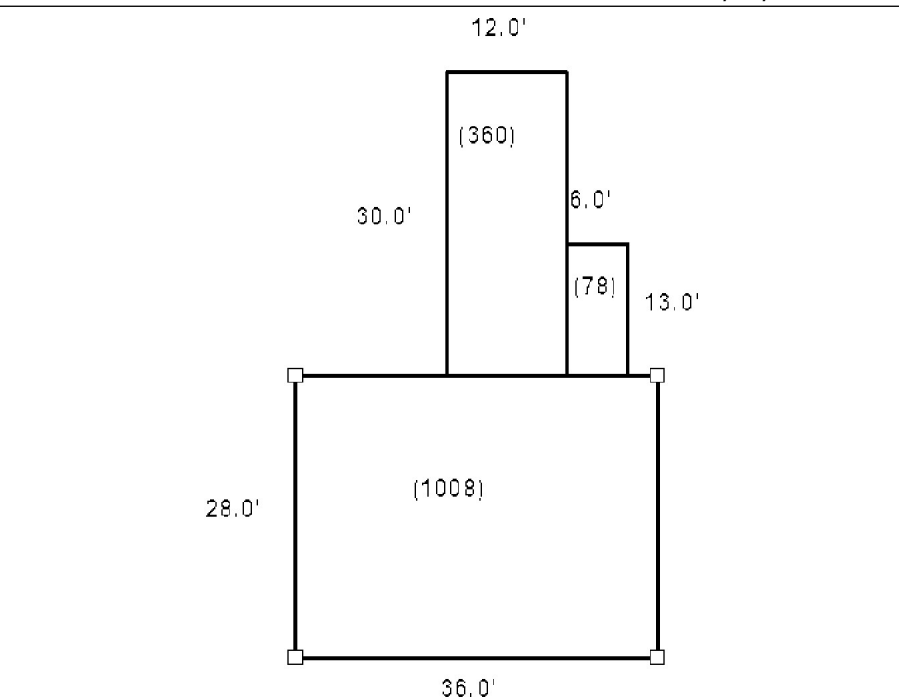

Bowdoin

Map Lot 11-17-0

Account 1182

Location LEWIS HILL RD

Card 1 Of 1 7/22/2022

Building Style 0 Not Coded	SF Bsmt Living 0	Layout 0
0.Not Code 4.Cape 8.Log	Fin Bsmt Grade 0 0	1.Typical 4. 7.
1.Conv. 5.Garrison 9.Other	OCCUPANCY 0	2.Inadeq 5. 8.
2.Ranch 6.Split 10.DW	Heat Type 100% 0 Not Coded	3.Poor 6. 9.
3.R Ranch 7.Contemp 11.Church	0.Not Code 4.Steam 8.FI/Wall	Attic 0
Dwelling Units 0	1.HWBB 5.FWA 9.No Heat	1.1/4 Fin 4.Full Fin 7.
Other Units 0	2.HWCI 6.GravWA 11.	2.1/2 Fin 5.FI/Stair 8.
Stories 0	3.H Pump 7.Electric 12.	3.3/4 Fin 6. 9.None
1.1 4.1.5 7.4	Cool Type 0% 9 None	Insulation 0
2.2 5.1.75 8.20	1.Refrig 4.W&C Air 7.	1.Full 4.Minimal 7.
3.3 6.2.5 9.Yurt	2.Evapor 5. 8.	2.Heavy 5. 8.
Exterior Walls 0 Not Coded	3.H Pump 6. 9.None	3.Capped 6. 9.None
0.Not Code 4.Asbestos 8.Concrete	Kitchen Style 0	Unfinished % 0%
1.Wood 5.Stucco 9.Other	1.Modern 4.Obsolete 7.	Grade & Factor 0 0%
2.Vin/Al 6.Brick 10.Board B	2.Typical 5. 8.	1.E Grade 4.B Grade 7.
3.Compos. 7.Stone 12.	3.Old Type 6. 9.None	2.D Grade 5.A Grade 8.
Roof Surface 0	Bath(s) Style 0	3.C Grade 6.AA Grade 9.Same
1.Asphalt 4.Composit 7.	1.Modern 4.Obsolete 7.	SQFT (Footprint) 0
2.Slate 5.Wood 8.	2.Typical 5. 8.	Condition 0
3.Metal 6.Other 9.	3.Old Type 6. 9.None	1.Poor 4.Avg 7.V G
SF Masonry Trim 0	# Rooms 0	2.Fair 5.Avg+ 8.Exc
SEPTIC DESIGN 0	# Bedrooms 0	3.Avg- 6.Good 9.Same
BLDG PERMIT 0	# Full Baths 0	Phys. % Good 0%
Year Built 0	# Half Baths 0	Funct. % Good 100%
Year Remodeled 0	# Addn Fixtures 0	Functional Code 9 None
Foundation 0	# Fireplaces 0	1.Incomp 4.Delap 7.No Power
1.Concrete 4.Wood 7.		2.O-Built 5.Bsmt 8.LongTerm
2.C Block 5.Slab 8.		3.Damage 6.Dbwd 9.None
3.Br/Stone 6.Piers 9.		Econ. % Good 100%
Basement 0		Economic Code None
1.1/4 Bmt 4.Full Bmt 7.		0.None 3.No Power 7.
2.1/2 Bmt 5.None 8.		1.Location 4.Generate 8.
3.3/4 Bmt 6. 9.None		2.Encroach 9.None 9.
Bsmt Gar # Cars 0		Entrance Code 0
Wet Basement 0		1.Interior 4.Vacant 7.Entered
1.Dry 4. 7.		2.Refusal 5.Estimate 8.No
2.Damp 5. 8.	3.Informed 6.Reviewed 9.Land	
3.Wet 6. 9.	Information Code 0	
	1.Owner 4.Agent 7.	
	2.Relative 5.Estimate 8.	
	3.Tenant 6.Other 9.	

Date Inspected

Additions, Outbuildings & Improvements

Type	Year	Units	Grade	Cond	Phys.	Funct.	Sound Value
					%	%	1.One Story Fram
					%	%	2.Two Story Fram
					%	%	3.Three Story Fr
					%	%	4.1 & 1/2 Story
					%	%	5.1 & 3/4 Story
					%	%	6.2 & 1/2 Story
					%	%	21.Open Frame Por
					%	%	22.Encl Frame Por
					%	%	23.Attached Garag
					%	%	24.Frame Shed
					%	%	25.Frame Bay Wind
					%	%	26.1SFr Overhang
					%	%	27.Unfin Basement
					%	%	28.Unfinished Att
					%	%	29.Finished Attic

NORTHERN NEW ENGLAND TELEPHONE OPERATIONS LLC
FAIRPOINT COMMUNICATIONS TAX DEPT
MANCHESTER NH 03101

B2970P230

Previous Owner
VERIZON NEW ENGLAND
P.O. BOX 152206

IRVING TX 75015
Sale Date: 3/27/2008

Inspection Witnessed By:

X	Date	
No./Date	Description	Date Insp.

Notes:

Bowdoin

Property Data			Assessment Record						
Neighborhood 11 Map 11			Year	Land	Buildings	Exempt	Total		
Tree Growth Year 0			2009	0	0	0	0		
Farmland Yr 0			2010	0	0	0	0		
Open Space Yr 0			2013	0	0	0	0		
Zone/Land Use 11 Residential 1			2014	0	0	0	0		
Secondary Zone			2015	0	0	0	0		
Topography			2016	0	0	0	0		
1.Level 4.Below St 7.LevelBog			2017	0	0	0	0		
2.Rolling 5.Low 8.Conform			2018	0	0	0	0		
3.Above St 6.FZone 9.Non-Confor			2019	0	0	0	0		
Utilities			2020	0	0	0	0		
1.Public 4.Dr Well 7.Cesspool			2021	0	0	0	0		
2.Water 5.Dug Well 8.			2022	0	0	0	0		
3.Sewer 6.Septic 9.None									
Street 1 Paved									
1.Paved 4.Proposed 7.MHG			Land Data						
2.Semi Imp 5.R/O/W 8.DIS			Front Foot	Type	Effective		Influence		Influence Codes
3.Gravel 6.MHP 9.None					Frontage	Depth	Factor	Code	
TG PLAN YEAR 0			11.Road Frontage					1.Unimproved	
Tif District # 0			12.Delta Triangle					2.Excess Frtg	
Sale Data			13.Nabla Triangle					3.Topography	
Sale Date 3/27/2008			14.Rear Land					4.Size/Shape	
Price			15.Miscellaneous					5.Access	
Sale Type 5 Other								6.Restriction	
1.Land 4.Mobile 7.C/I L&B			Square Foot	Square Feet				7.Open Space	
2.L & B 5.Other 8.								8.View/Environ	
3.Building 6.C/I Land 9.			16.Regular Lot					9.Fract Share	
Financing 9 Unknown			17.Secondary Lot						
1.Convent 4.Seller 7.			18.Hydro Facility					30.Rear Land 3	
2.FHA/VA 5.Private 8.			19.Improvements					31.Tillable	
3.Assumed 6.Cash 9.Unknown			20.Base 3 (Fract)					32.Pasture	
Validity 1 Arms Length Sale								33.Orchard	
1.Valid 4.Split 7.Renovate			Fract. Acre	Acreeage/Sites				34.Softwood F&O	
2.Related 5.Partial 8.Other			21.Base 1 (Fract)					35.Mixed Wood F&O	
3.Distress 6.Exempt 9.Short			22.Base 2 (Fract)					36.Hardwood F&O	
Verified 5 Public Record			23.Base 3					37.Softwood TG	
1.Buyer 4.Agent 7.Family								38.Mixed Wood TG	
2.Seller 5.Pub Rec 8.Other			Acres					39.Hardwood TG	
3.Lender 6.MLS 9.			24.Base 1					40.Wasteland	
			25.Base 2					41.Commercial	
			26.Frontage 1					42.2nd Site	
			27.Rear Land 4					43.Post Rd	
			28.Rear Land 1					44.Lot Improvemen	
			29.Rear Land 2					45.Subdivision Lo	
			Total Acreage			0.00		46.Golf Course	

JACK, RONALD B
823 LEWIS HILL RD
BOWDOIN ME 04287

B1777P235

Inspection Witnessed By:

X

Date

No./Date	Description	Date Insp.

Notes:

Bowdoin

Property Data			Assessment Record				
Neighborhood 11 Map 11			Year	Land	Buildings	Exempt	Total
Tree Growth Year 1980			2009	64,960	132,170	10,000	187,130
Farmland Yr 0			2010	65,460	132,170	10,000	187,630
Open Space Yr 0			2011	68,460	132,170	10,000	190,630
Zone/Land Use 11 Residential 1			2012	68,490	132,170	10,000	190,660
Secondary Zone			2013	65,130	132,170	10,000	187,300
Topography 6 Flood Zone			2014	65,060	132,170	10,000	187,230
1.Level 4.Below St 7.LevelBog			2015	64,800	132,170	10,000	186,970
2.Rolling 5.Low 8.Conform			2016	68,620	132,170	15,000	185,790
3.Above St 6.FZone 9.Non-Confor			2017	69,310	132,170	20,000	181,480
Utilities			2018	69,960	132,170	20,000	182,130
1.Public 4.Dr Well 7.Cesspool			2019	69,800	132,170	20,000	181,970
2.Water 5.Dug Well 8.			2020	70,120	132,170	25,000	177,290
3.Sewer 6.Septic 9.None			2021	70,140	132,170	25,000	177,310
Street 1 Paved			2022	67,430	125,080	21,500	171,010
1.Paved 4.Proposed 7.MHG			Land Data				
2.Semi Imp 5.R/O/W 8.DIS							
3.Gravel 6.MHP 9.None			Front Foot				
TG PLAN YEAR 2020							
Tif District # 0			Type				
Sale Data							
Sale Date			Effective				
Price							
Sale Type			Influence				
1.Land 4.Mobile 7.C/I L&B							
2.L & B 5.Other 8.			Influence Codes				
3.Building 6.C/I Land 9.							
Financing			Square Foot				
1.Convent 4.Seller 7.							
2.FHA/VA 5.Private 8.			Square Feet				
3.Assumed 6.Cash 9.Unknown							
Validity			Fract. Acre				
1.Valid 4.Split 7.Renovate							
2.Related 5.Partial 8.Other			Acres				
3.Distress 6.Exempt 9.Short							
Verified			Acres/Sites				
1.Buyer 4.Agent 7.Family							
2.Seller 5.Pub Rec 8.Other			Total Acreage 51.00				
3.Lender 6.MLS 9.							

- 1.Unimproved
- 2.Excess Frtg
- 3.Topography
- 4.Size/Shape
- 5.Access
- 6.Restriction
- 7.Open Space
- 8.View/Environ
- 9.Fract Share
- Acres**
- 30.Rear Land 3
- 31.Tillable
- 32.Pasture
- 33.Orchard
- 34.Softwood F&O
- 35.Mixed Wood F&O
- 36.Hardwood F&O
- 37.Softwood TG
- 38.Mixed Wood TG
- 39.Hardwood TG
- 40.Wasteland
- 41.Commercial
- 42.2nd Site
- 43.Post Rd
- 44.Lot Improvemen
- 45.Subdivision Lo
- 46.Golf Course

Bowdoin

Map Lot 11-18-0

Account 1183

Location 823 LEWIS HILL RD

Card 1 Of 2 7/22/2022

Building Style 8 Log Home	SF Bsmt Living 0	Layout 1 Typical
0.Not Code 4.Cape 8.Log	Fin Bsmt Grade 0 0	1.Typical 4. 7.
1.Conv. 5.Garrison 9.Other	OCCUPANCY 0	2.Inadeq 5. 8.
2.Ranch 6.Split 10.DW	Heat Type 100% 5 Forced Warm Air	3.Poor 6. 9.
3.R Ranch 7.Contemp 11.Church	0.Not Code 4.Steam 8.FI/Wall	Attic 9 None
Dwelling Units 1	1.HWBB 5.FWA 9.No Heat	1.1/4 Fin 4.Full Fin 7.
Other Units 0	2.HWCI 6.GravWA 11.	2.1/2 Fin 5.FI/Stair 8.
Stories 4 One & 1/2 Story	3.H Pump 7.Electric 12.	3.3/4 Fin 6. 9.None
1.1 4.1.5 7.4	Cool Type 0% 9 None	Insulation 1 Full
2.2 5.1.75 8.20	1.Refrig 4.W&C Air 7.	1.Full 4.Minimal 7.
3.3 6.2.5 9.Yurt	2.Evapor 5. 8.	2.Heavy 5. 8.
Exterior Walls 1 Wood Siding	3.H Pump 6. 9.None	3.Capped 6. 9.None
0.Not Code 4.Asbestos 8.Concrete	Kitchen Style 2 Typical	Unfinished % 0%
1.Wood 5.Stucco 9.Other	1.Modern 4.Obsolete 7.	Grade & Factor 3 Average 100%
2.Vin/Al 6.Brick 10.Board B	2.Typical 5. 8.	1.E Grade 4.B Grade 7.
3.Compos. 7.Stone 12.	3.Old Type 6. 9.None	2.D Grade 5.A Grade 8.
Roof Surface 1 Asphalt Shingles	Bath(s) Style 2 Typical Bath(s)	3.C Grade 6.AA Grade 9.Same
1.Asphalt 4.Composit 7.	1.Modern 4.Obsolete 7.	SQFT (Footprint) 720
2.Slate 5.Wood 8.	2.Typical 5. 8.	Condition 4 Average
3.Metal 6.Other 9.	3.Old Type 6. 9.None	1.Poor 4.Avg 7.V G
SF Masonry Trim 0	# Rooms 3	2.Fair 5.Avg+ 8.Exc
SEPTIC DESIGN 0	# Bedrooms 2	3.Avg- 6.Good 9.Same
BLDG PERMIT 0	# Full Baths 1	Phys. % Good 0%
Year Built 1976	# Half Baths 0	Funct. % Good 100%
Year Remodeled 0	# Addn Fixtures 0	Functional Code 9 None
Foundation 1 Concrete	# Fireplaces 0	1.Incomp 4.Delap 7.No Power
1.Concrete 4.Wood 7.		2.O-Built 5.Bsmt 8.LongTerm
2.C Block 5.Slab 8.		3.Damage 6.Dbwld 9.None
3.Br/Stone 6.Piers 9.		Econ. % Good 100%
Basement 4 Full Basement		Economic Code None
1.1/4 Bmt 4.Full Bmt 7.		0.None 3.No Power 7.
2.1/2 Bmt 5.None 8.		1.Location 4.Generate 8.
3.3/4 Bmt 6. 9.None		2.Encroach 9.None 9.
Bsmt Gar # Cars 0		Entrance Code 3 Information Only
Wet Basement 1 Dry Basement		1.Interior 4.Vacant 7.Entered
1.Dry 4. 7.		2.Refusal 5.Estimate 8.No
2.Damp 5. 8.		3.Informed 6.Reviewed 9.Land
3.Wet 6. 9.		Information Code 1 Owner
		1.Owner 4.Agent 7.
		2.Relative 5.Estimate 8.
		3.Tenant 6.Other 9.

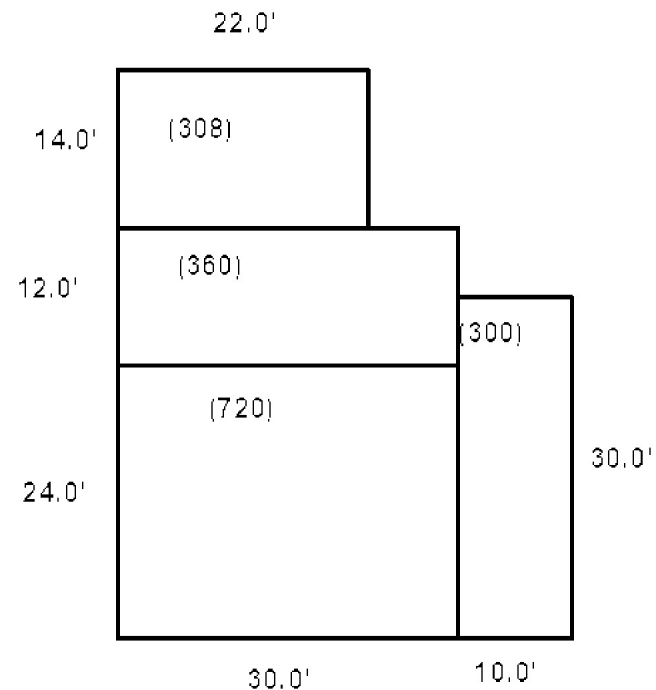

Date Inspected

Additions, Outbuildings & Improvements

Type	Year	Units	Grade	Cond	Phys.	Funct.	Sound Value
1 One Story Frame	0	360	0 0	0	0 %	0 %	
21 Open Frame	0	300	0 0	0	0 %	0 %	
22 Encl Frame Porch	1983	308	0 0	0	0 %	0 %	
65 Barn	0	240	2 100	3	0 %	100 %	
					%	%	
					%	%	
					%	%	
					%	%	
					%	%	
					%	%	
					%	%	
					%	%	



JACK, RONALD B
823 LEWIS HILL RD
BOWDOIN ME 04287

B1777P235

Property Data			Assessment Record																																																																																																																																																																																
			Year	Land	Buildings	Exempt	Total																																																																																																																																																																												
Neighborhood 11 Map 11			2009	3,000	0	0	3,000																																																																																																																																																																												
Tree Growth Year 1980			2010	3,000	0	0	3,000																																																																																																																																																																												
Farmland Yr 0			2013	3,000	0	0	3,000																																																																																																																																																																												
Open Space Yr 0			2014	3,000	0	0	3,000																																																																																																																																																																												
Zone/Land Use 11 Residential 1			2015	3,000	0	0	3,000																																																																																																																																																																												
Secondary Zone			2016	3,000	0	0	3,000																																																																																																																																																																												
Topography			2017	3,000	0	0	3,000																																																																																																																																																																												
1.Level 4.Below St 7.LevelBog			2018	3,000	0	0	3,000																																																																																																																																																																												
2.Rolling 5.Low 8.Conform			2019	3,000	0	0	3,000																																																																																																																																																																												
3.Above St 6.FZone 9.Non-Confor			2020	3,000	0	0	3,000																																																																																																																																																																												
Utilities			2021	3,000	0	0	3,000																																																																																																																																																																												
1.Public 4.Dr Well 7.Cesspool			2022	3,000	0	0	3,000																																																																																																																																																																												
2.Water 5.Dug Well 8.																																																																																																																																																																																			
3.Sewer 6.Septic 9.None																																																																																																																																																																																			
Street 1 Paved			Land Data																																																																																																																																																																																
1.Paved 4.Proposed 7.MHG																																																																																																																																																																																			
2.Semi Imp 5.R/O/W 8.DIS			Front Foot																																																																																																																																																																																
3.Gravel 6.MHP 9.None																																																																																																																																																																																			
TG PLAN YEAR 2010			<table border="1"> <thead> <tr> <th rowspan="2">Type</th> <th colspan="2">Effective</th> <th colspan="2">Influence</th> <th rowspan="2">Influence Codes</th> </tr> <tr> <th>Frontage</th> <th>Depth</th> <th>Factor</th> <th>Code</th> </tr> </thead> <tbody> <tr><td>11.Road Frontage</td><td></td><td></td><td>%</td><td></td><td>1.Unimproved</td></tr> <tr><td>12.Delta Triangle</td><td></td><td></td><td>%</td><td></td><td>2.Excess Frtg</td></tr> <tr><td>13.Nabla Triangle</td><td></td><td></td><td>%</td><td></td><td>3.Topography</td></tr> <tr><td>14.Rear Land</td><td></td><td></td><td>%</td><td></td><td>4.Size/Shape</td></tr> <tr><td>15.Miscellaneous</td><td></td><td></td><td>%</td><td></td><td>5.Access</td></tr> <tr><td></td><td></td><td></td><td>%</td><td></td><td>6.Restriction</td></tr> <tr><td></td><td></td><td></td><td>%</td><td></td><td>7.Open Space</td></tr> <tr><td></td><td></td><td></td><td>%</td><td></td><td>8.View/Environ</td></tr> <tr><td></td><td></td><td></td><td>%</td><td></td><td>9.Fract Share</td></tr> <tr><td></td><td></td><td></td><td>%</td><td></td><td>Acres</td></tr> <tr><td></td><td></td><td></td><td>%</td><td></td><td>30.Rear Land 3</td></tr> <tr><td></td><td></td><td></td><td>%</td><td></td><td>31.Tillable</td></tr> <tr><td></td><td></td><td></td><td>%</td><td></td><td>32.Pasture</td></tr> <tr><td></td><td></td><td></td><td>%</td><td></td><td>33.Orchard</td></tr> <tr><td></td><td></td><td></td><td>%</td><td></td><td>34.Softwood F&O</td></tr> <tr><td></td><td></td><td></td><td>%</td><td></td><td>35.Mixed Wood F&O</td></tr> <tr><td></td><td></td><td></td><td>%</td><td></td><td>36.Hardwood F&O</td></tr> <tr><td></td><td></td><td></td><td>%</td><td></td><td>37.Softwood TG</td></tr> <tr><td></td><td></td><td></td><td>%</td><td></td><td>38.Mixed Wood TG</td></tr> <tr><td></td><td></td><td></td><td>%</td><td></td><td>39.Hardwood TG</td></tr> <tr><td></td><td></td><td></td><td>%</td><td></td><td>40.Wasteland</td></tr> <tr><td></td><td></td><td></td><td>%</td><td></td><td>41.Commercial</td></tr> <tr><td></td><td></td><td></td><td>%</td><td></td><td>42.2nd Site</td></tr> <tr><td></td><td></td><td></td><td>%</td><td></td><td>43.Post Rd</td></tr> <tr><td></td><td></td><td></td><td>%</td><td></td><td>44.Lot Improvemen</td></tr> <tr><td></td><td></td><td></td><td>%</td><td></td><td>45.Subdivision Lo</td></tr> <tr><td></td><td></td><td></td><td>%</td><td></td><td>46.Golf Course</td></tr> </tbody> </table>					Type	Effective		Influence		Influence Codes	Frontage	Depth	Factor	Code	11.Road Frontage			%		1.Unimproved	12.Delta Triangle			%		2.Excess Frtg	13.Nabla Triangle			%		3.Topography	14.Rear Land			%		4.Size/Shape	15.Miscellaneous			%		5.Access				%		6.Restriction				%		7.Open Space				%		8.View/Environ				%		9.Fract Share				%		Acres				%		30.Rear Land 3				%		31.Tillable				%		32.Pasture				%		33.Orchard				%		34.Softwood F&O				%		35.Mixed Wood F&O				%		36.Hardwood F&O				%		37.Softwood TG				%		38.Mixed Wood TG				%		39.Hardwood TG				%		40.Wasteland				%		41.Commercial				%		42.2nd Site				%		43.Post Rd				%		44.Lot Improvemen				%		45.Subdivision Lo				%		46.Golf Course
Type	Effective								Influence		Influence Codes																																																																																																																																																																								
	Frontage	Depth	Factor	Code																																																																																																																																																																															
11.Road Frontage			%		1.Unimproved																																																																																																																																																																														
12.Delta Triangle			%		2.Excess Frtg																																																																																																																																																																														
13.Nabla Triangle			%		3.Topography																																																																																																																																																																														
14.Rear Land			%		4.Size/Shape																																																																																																																																																																														
15.Miscellaneous			%		5.Access																																																																																																																																																																														
			%		6.Restriction																																																																																																																																																																														
			%		7.Open Space																																																																																																																																																																														
			%		8.View/Environ																																																																																																																																																																														
			%		9.Fract Share																																																																																																																																																																														
			%		Acres																																																																																																																																																																														
			%		30.Rear Land 3																																																																																																																																																																														
			%		31.Tillable																																																																																																																																																																														
			%		32.Pasture																																																																																																																																																																														
			%		33.Orchard																																																																																																																																																																														
			%		34.Softwood F&O																																																																																																																																																																														
			%		35.Mixed Wood F&O																																																																																																																																																																														
			%		36.Hardwood F&O																																																																																																																																																																														
			%		37.Softwood TG																																																																																																																																																																														
			%		38.Mixed Wood TG																																																																																																																																																																														
			%		39.Hardwood TG																																																																																																																																																																														
			%		40.Wasteland																																																																																																																																																																														
			%		41.Commercial																																																																																																																																																																														
			%		42.2nd Site																																																																																																																																																																														
			%		43.Post Rd																																																																																																																																																																														
			%		44.Lot Improvemen																																																																																																																																																																														
			%		45.Subdivision Lo																																																																																																																																																																														
			%		46.Golf Course																																																																																																																																																																														
Street 1 Paved			Square Foot																																																																																																																																																																																
1.Paved 4.Proposed 7.MHG																																																																																																																																																																																			
2.Semi Imp 5.R/O/W 8.DIS			Fract. Acre																																																																																																																																																																																
3.Gravel 6.MHP 9.None																																																																																																																																																																																			
TG PLAN YEAR 2010			Acres																																																																																																																																																																																
Tif District # 0																																																																																																																																																																																			
Sale Data			Total Acreage 1.00																																																																																																																																																																																
Sale Date																																																																																																																																																																																			
Price			Acres																																																																																																																																																																																
Sale Type																																																																																																																																																																																			
1.Land 4.Mobile 7.C/I L&B			Acres																																																																																																																																																																																
2.L & B 5.Other 8.																																																																																																																																																																																			
3.Building 6.C/I Land 9.			Acres																																																																																																																																																																																
Financing																																																																																																																																																																																			
1.Convent 4.Seller 7.			Acres																																																																																																																																																																																
2.FHA/VA 5.Private 8.																																																																																																																																																																																			
3.Assumed 6.Cash 9.Unknown			Acres																																																																																																																																																																																
Validity																																																																																																																																																																																			
1.Valid 4.Split 7.Renovate			Acres																																																																																																																																																																																
2.Related 5.Partial 8.Other																																																																																																																																																																																			
3.Distress 6.Exempt 9.Short			Acres																																																																																																																																																																																
Verified																																																																																																																																																																																			
1.Buyer 4.Agent 7.Family			Acres																																																																																																																																																																																
2.Seller 5.Pub Rec 8.Other																																																																																																																																																																																			
3.Lender 6.MLS 9.			Acres																																																																																																																																																																																

Inspection Witnessed By:

No./Date	Description	Date Insp.
X		

Notes:

Bowdoin

Bowdoin

Map Lot 11-18-0

Account 1183

Location 823 LEWIS HILL RD

Card 2 Of 2 7/22/2022

Building Style	SF Bsmt Living	Layout
0.Not Code 4.Cape 8.Log	Fin Bsmt Grade	1.Typical 4. 7.
1.Conv. 5.Garrison 9.Other	OCCUPANCY	2.Inadeq 5. 8.
2.Ranch 6.Split 10.DW	Heat Type 100%	3.Poor 6. 9.
3.R Ranch 7.Contemp 11.Church	0.Not Code 4.Steam 8.Fi/Wall	Attic
Dwelling Units	1.HWBB 5.FWA 9.No Heat	1.1/4 Fin 4.Full Fin 7.
Other Units	2.HWCI 6.GravWA 11.	2.1/2 Fin 5.Fi/Stair 8.
Stories	3.H Pump 7.Electric 12.	3.3/4 Fin 6. 9.None
1.1 4.1.5 7.4	Cool Type 0%	Insulation
2.2 5.1.75 8.20	1.Refrig 4.W&C Air 7.	1.Full 4.Minimal 7.
3.3 6.2.5 9.Yurt	2.Evapor 5. 8.	2.Heavy 5. 8.
Exterior Walls	3.H Pump 6. 9.None	3.Capped 6. 9.None
0.Not Code 4.Asbestos 8.Concrete	Kitchen Style	Unfinished %
1.Wood 5.Stucco 9.Other	1.Modern 4.Obsolete 7.	Grade & Factor
2.Vin/Al 6.Brick 10.Board B	2.Typical 5. 8.	1.E Grade 4.B Grade 7.
3.Compos. 7.Stone 12.	3.Old Type 6. 9.None	2.D Grade 5.A Grade 8.
Roof Surface	Bath(s) Style	3.C Grade 6.AA Grade 9.Same
1.Asphalt 4.Composit 7.	1.Modern 4.Obsolete 7.	SQFT (Footprint)
2.Slate 5.Wood 8.	2.Typical 5. 8.	Condition
3.Metal 6.Other 9.	3.Old Type 6. 9.None	1.Poor 4.Avg 7.V G
SF Masonry Trim	# Rooms	2.Fair 5.Avg+ 8.Exc
SEPTIC DESIGN	# Bedrooms	3.Avg- 6.Good 9.Same
BLDG PERMIT	# Full Baths	Phys. % Good
Year Built	# Half Baths	Funct. % Good
Year Remodeled	# Addn Fixtures	Functional Code
Foundation	# Fireplaces	1.Incomp 4.Delap 7.No Power
1.Concrete 4.Wood 7.		2.O-Built 5.Bsmt 8.LongTerm
2.C Block 5.Slab 8.		3.Damage 6.Dbwd 9.None
3.Br/Stone 6.Piers 9.		Econ. % Good
Basement		Economic Code
1.1/4 Bmt 4.Full Bmt 7.		0.None 3.No Power 7.
2.1/2 Bmt 5.None 8.		1.Location 4.Generate 8.
3.3/4 Bmt 6. 9.None		2.Encroach 9.None 9.
Bsmt Gar # Cars		Entrance Code 0
Wet Basement		1.Interior 4.Vacant 7.Entered
1.Dry 4. 7.		2.Refusal 5.Estimate 8.No
2.Damp 5. 8.	3.Informed 6.Reviewed 9.Land	
3.Wet 6. 9.	Information Code 0	
	1.Owner 4.Agent 7.	
	2.Relative 5.Estimate 8.	
	3.Tenant 6.Other 9.	

Date Inspected

Additions, Outbuildings & Improvements

Type	Year	Units	Grade	Cond	Phys.	Funct.	Sound Value
					%	%	1.One Story Fram
					%	%	2.Two Story Fram
					%	%	3.Three Story Fr
					%	%	4.1 & 1/2 Story
					%	%	5.1 & 3/4 Story
					%	%	6.2 & 1/2 Story
					%	%	21.Open Frame Por
					%	%	22.Encl Frame Por
					%	%	23.Attached Garag
					%	%	24.Frame Shed
					%	%	25.Frame Bay Wind
					%	%	26.1SFr Overhang
					%	%	27.Unfin Basement
					%	%	28.Unfinished Att
					%	%	29.Finished Attic